

Appendix A2

Detailed Intersection Upgrades

LEGEND

GENERAL

- EXISTING PAVEMENT
- SURVEY
- CADASTRAL (ACCURACY UNKNOWN)
- SITE BOUNDARY (SWTC APP.2)
- SITE BOUNDARY OFFSET (DISTANCE VARIES)
- LOCAL ROAD CORRIDOR BOUNDARY (AS MODIFIED FOR TENDER DESIGN)
- LOCAL ROAD CORRIDOR BOUNDARY (SWTC APP.3)
- AREA OF TEMPORARY PAVEMENTS

NOTES

1. FOR FURTHER DETAIL ON CLEARING EXTENTS REFER DRAWINGS NH2UJ-DG-EV-0001 TO 0048.
2. FOR FURTHER DETAIL ON PROPERTY WORKS REFER DRAWINGS NH2UJ-DG-PA-0001 TO 0125.

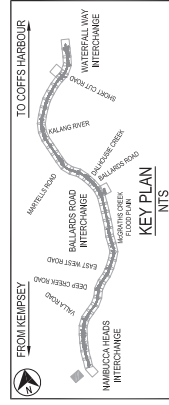









TITLE		DATE	BY	CHKD	APP'D	SCALE	DATE	BY	CHKD	APP'D	SCALE	DATE	BY	CHKD	APP'D
TRAFFIC MANAGEMENT SUBMISSION		31.07.2012	S.Z.T.	B.J.	F.N.	AS SHOWN	05.08.2012	S.Z.T.	B.J.	F.N.	AS SHOWN	05.08.2012	S.Z.T.	B.J.	F.N.
TENDER SUBMISSION		05.08.2012	S.Z.T.	B.J.	F.N.	AS SHOWN	05.08.2012	S.Z.T.	B.J.	F.N.	AS SHOWN	05.08.2012	S.Z.T.	B.J.	F.N.

CLIENT	NSW	TRANSPORT ROADS & MARITIME SERVICES
CONSULTANT	Abigroup	Constructing Australia's Future
PROJECT	NAMBURCA AND BELLINGEN SHIRE COUNCILS PACIFIC HIGHWAY UPGRADE NAMBURCA HEADS TO URUNGA HORIZONTAL & VERTICAL DESIGN TEMPORARY WORKS SITE ACCESS - IRONBARK TRAIL	
STATUS	TMP SUBMISSION	
VOLUME	TMP	
PHASE	TE	
REV	NH2UJ-DG-RD-0501	
REV	B	

LEGEND

GENERAL

-  EXISTING PAVEMENT
-  SURVEY
-  CADASTRAL (ACCURACY UNKNOWN)
-  SITE BOUNDARY (SWTC APP.2)
-  SITE BOUNDARY OFFSET (DISTANCE VARIES)
-  LOCAL ROAD CORRIDOR BOUNDARY (AS MODIFIED FOR TENDER DESIGN)
-  LOCAL ROAD CORRIDOR BOUNDARY (SWTC APP.3)
-  AREA OF TEMPORARY PAVEMENTS

NOTES

1. FOR FURTHER DETAIL ON CLEARING EXTENTS REFER DRAWINGS NH2UJ-DG-EV-0001 TO 0048.
2. FOR FURTHER DETAIL ON PROPERTY WORKS REFER DRAWINGS NH2UJ-DG-PA-0001 TO 0125.

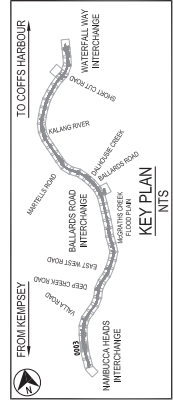

PROJECT		CONTRACTOR		CLIENT		SCALE		DATE		DATE		DATE		DATE		DATE		DATE	
NAMBUCCA AND BELLINGEN SHIRE COUNCILS		Abigroup		Transport Roads & Maritime Services		SCALE 1:2000		DATE 05/08/2012		DATE 05/08/2012		DATE 05/08/2012		DATE 05/08/2012		DATE 05/08/2012		DATE 05/08/2012	
PACIFIC HIGHWAY UPGRADE		Constructing Australia's Future		NSW		SCALE 1:2000		DATE 05/08/2012		DATE 05/08/2012		DATE 05/08/2012		DATE 05/08/2012		DATE 05/08/2012		DATE 05/08/2012	
NAMBUCCA HEADS TO URUNGA						SCALE 1:2000		DATE 05/08/2012		DATE 05/08/2012		DATE 05/08/2012		DATE 05/08/2012		DATE 05/08/2012		DATE 05/08/2012	
HORIZONTAL & VERTICAL DESIGN						SCALE 1:2000		DATE 05/08/2012		DATE 05/08/2012		DATE 05/08/2012		DATE 05/08/2012		DATE 05/08/2012		DATE 05/08/2012	
TEMPORARY WORKS						SCALE 1:2000		DATE 05/08/2012		DATE 05/08/2012		DATE 05/08/2012		DATE 05/08/2012		DATE 05/08/2012		DATE 05/08/2012	
NAMBUCCA HEADS INTECHARGE SWITCH						SCALE 1:2000		DATE 05/08/2012		DATE 05/08/2012		DATE 05/08/2012		DATE 05/08/2012		DATE 05/08/2012		DATE 05/08/2012	
TE		REV		REV		REV		REV		REV		REV		REV		REV		REV	
NH2UJ-DG-RD-0521		NH2UJ-DG-RD-0521		NH2UJ-DG-RD-0521		NH2UJ-DG-RD-0521		NH2UJ-DG-RD-0521		NH2UJ-DG-RD-0521		NH2UJ-DG-RD-0521		NH2UJ-DG-RD-0521		NH2UJ-DG-RD-0521		NH2UJ-DG-RD-0521	
B		B		B		B		B		B		B		B		B		B	

This drawing may have been prepared using computer software and may not be a true copy of the original.

LEGEND

- GENERAL**
- EXISTING PAVEMENT
 - SURVEY
 - CADASTRAL (ACCURACY UNKNOWN)
 - SITE BOUNDARY (SWTC APP.2)
 - SITE BOUNDARY OFFSET (DISTANCE VARIES)
 - LOCAL ROAD CORRIDOR BOUNDARY (AS MODIFIED FOR TENDER DESIGN)
 - LOCAL ROAD CORRIDOR BOUNDARY (SWTC APP.3)
 - AREA OF TEMPORARY PAVEMENTS

NOTES

- FOR FURTHER DETAIL ON CLEARING EXTENTS REFER DRAWINGS NH2U-DG-EV-0001 TO 0048.
- FOR FURTHER DETAIL ON PROPERTY WORKS REFER DRAWINGS NH2U-DG-PA-0001 TO 0125.

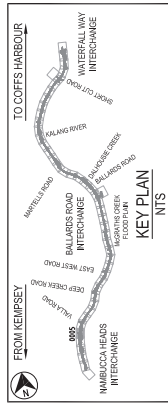
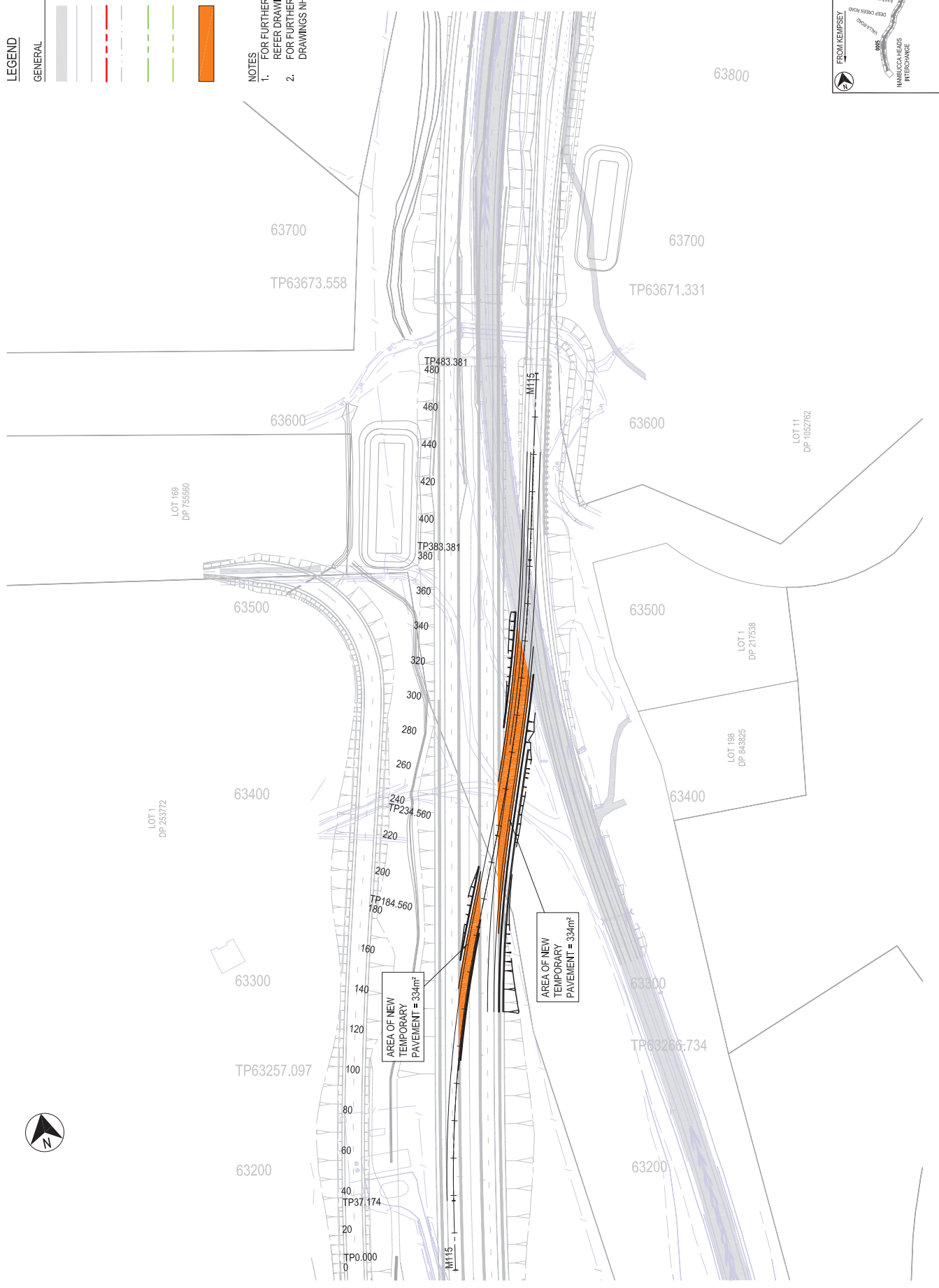

TITLE		DATE	BY	CHKD	DATE	BY	CHKD	DATE	BY	CHKD	DATE	BY	CHKD	DATE	BY	CHKD	DATE	BY	CHKD
TRAFFIC MANAGEMENT SUBMISSION		31.01.2012	S.Z.T.	B.J.	F.N.	S.K.M.A.M.A.N.G.A.R	F.H.	05.09.2012											
TENDER SUBMISSION		05.09.2012	D.L.	B.E.A.T.	F.N.	S.K.M.A.M.A.N.G.A.R	F.H.	05.09.2012											
DESIGN CHECK		05.09.2012	S.H.	A.M.	F.N.	S.K.M.A.M.A.N.G.A.R	F.H.	05.09.2012											
DRAWING CHECK		05.09.2012	S.H.	A.M.	F.N.	S.K.M.A.M.A.N.G.A.R	F.H.	05.09.2012											
SUPERVISOR		05.09.2012	S.H.	A.M.	F.N.	S.K.M.A.M.A.N.G.A.R	F.H.	05.09.2012											

SCALE	1:2000
SCALE	1:200
SCALE	1:200
SCALE	1:200

CLIENT	NSW
CLIENT	Transport Roads & Maritime Services
CLIENT	Abigroup
CLIENT	Constructing Australia's Future
PROJECT	NAMBUCCA AND BELINGEN SHIRE COUNCILS PACIFIC HIGHWAY UPGRADE NAMBUCCA HEADS TO URUNGA HORIZONTAL & VERTICAL DESIGN TEMPORARY WORKS COW CREEK SWITCH PLAN
STATUS	TMP SUBMISSION
VOLUME	DESIGN AND CONSTRUCTION CONTRACT
PHASE	TE
REV	NH2U-DG-RD-0531
REV	B

LEGEND

GENERAL

	EXISTING PAVEMENT
	SURVEY
	CADASTRAL (ACCURACY UNKNOWN)
	SITE BOUNDARY (SWTC APP.2)
	SITE BOUNDARY OFFSET (DISTANCE VARIES)
	LOCAL ROAD CORRIDOR BOUNDARY (AS MODIFIED FOR TENDER DESIGN)
	LOCAL ROAD CORRIDOR BOUNDARY (SWTC APP.3)
	AREA OF TEMPORARY PAVEMENTS

NOTES

1. FOR FURTHER DETAIL ON CLEARING EXTENTS REFER DRAWINGS NH2UJ-DG-EV-0001 TO 0048.
2. FOR FURTHER DETAIL ON PROPERTY WORKS REFER DRAWINGS NH2UJ-DG-PA-0001 TO 0125.

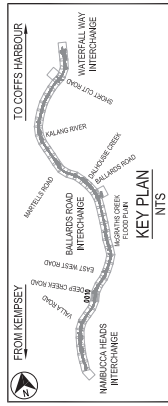
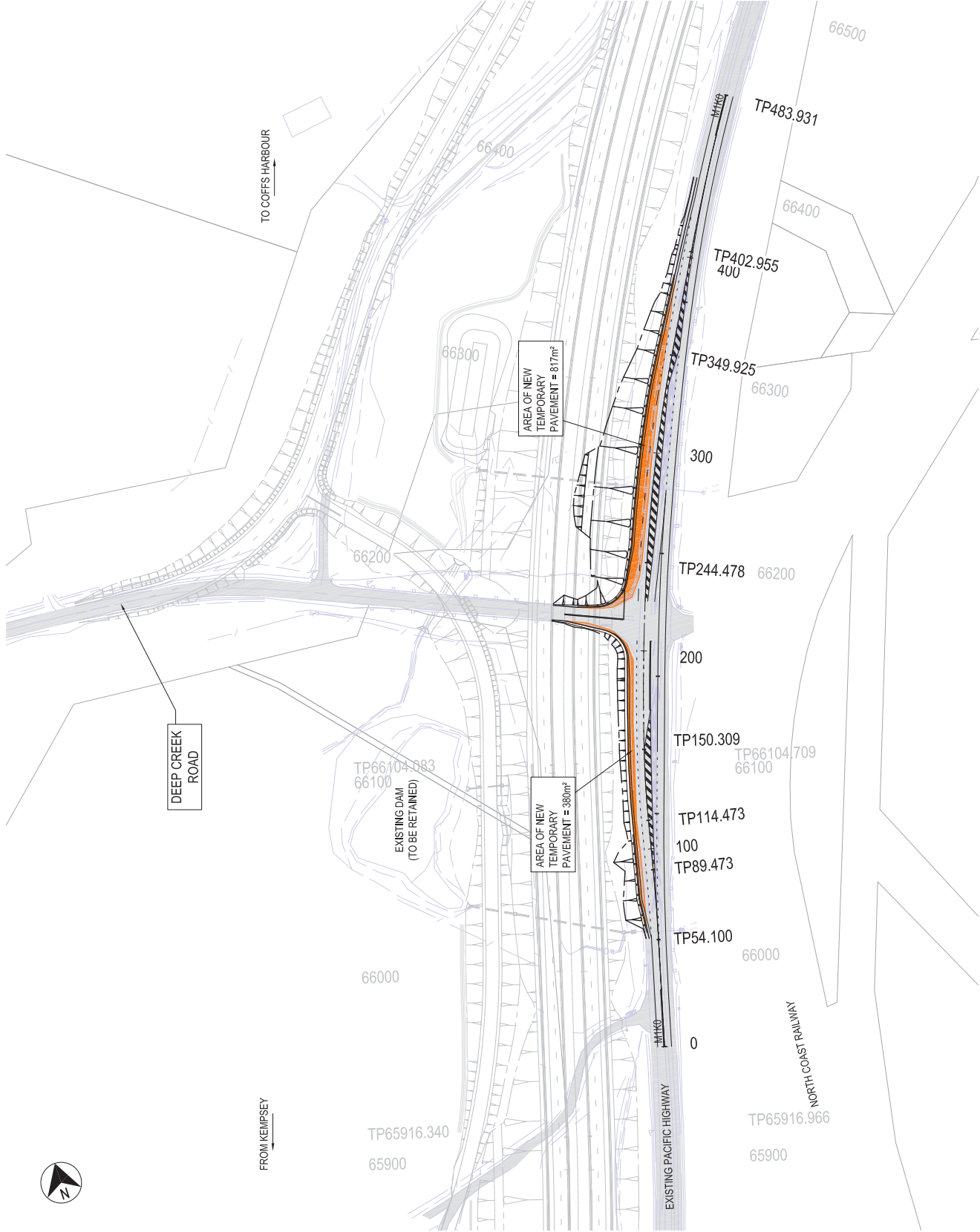

CLIENT  Transport, Roads & Maritime Services Constructing Australia's Future	CONTRACTOR  Abigroup Constructing Australia's Future	PROJECT NAMBURCA AND BELLINGEN SHIRE COUNCILS PACIFIC HIGHWAY UPGRADE NAMBURCA HEADS TO URUNGA HORIZONTAL & VERTICAL DESIGN TEMPORARY WORKS DEEP CREEK ROAD INTERSECTION	STATUS TMP SUBMISSION DESIGN AND CONTRACT CONTRACT		
				VOLUME TMP	PHASE TE
				REV B	REV B

TITLE	DATE	BY	CHKD BY
DESIGN CHECK	05.08.2012	S.H.	
DESIGNER	05.08.2012	A.M.	
DESIGN CHECK	05.08.2012	E.D.	
DESIGN MANAGER	05.08.2012	F.H.	
PROJECT MANAGER	05.08.2012	K.L.	



DATE	DESCRIPTION
31.01.2012	TRAFFIC MANAGEMENT SUBMISSION
05.08.2012	TENDER SUBMISSION

This Drawing may have been prepared using computer software for the purpose of design and/or construction.

LEGEND

- GENERAL**
- EXISTING PAVEMENT
 - SURVEY
 - CADASTRAL (ACCURACY UNKNOWN)
 - SITE BOUNDARY (SWTC APP.2)
 - SITE BOUNDARY OFFSET (DISTANCE VARIES)
 - LOCAL ROAD CORRIDOR BOUNDARY (AS MODIFIED FOR TENDER DESIGN)
 - LOCAL ROAD CORRIDOR BOUNDARY (SWTC APP.3)
 - AREA OF TEMPORARY PAVEMENTS

NOTES

- FOR FURTHER DETAIL ON CLEARING EXTENTS REFER DRAWINGS NH2UJ-DG-EV-0001 TO 0048.
- FOR FURTHER DETAIL ON PROPERTY WORKS REFER DRAWINGS NH2UJ-DG-PA-0001 TO 0125.

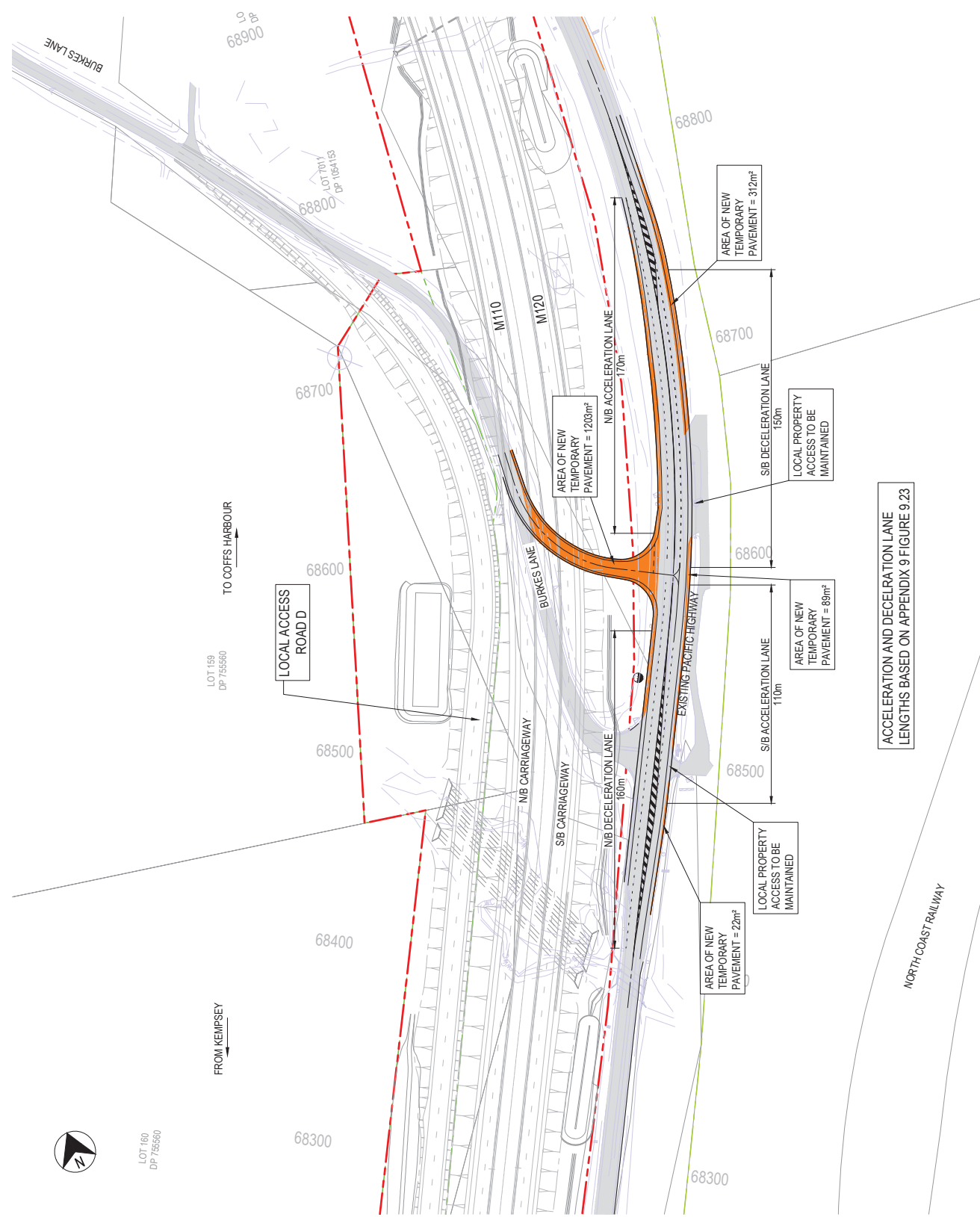

ACCELERATION AND DECELERATION LANE LENGTHS BASED ON APPENDIX 9 FIGURE 9.23

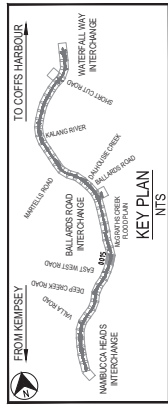

REV	DATE	DESCRIPTION	BY	CHKD	APP'D	SCALE	PROJECT	CLIENT	CONTRACTOR	STATUS	REVISION
A	05.09.2012	TENDER SUBMISSION	SZT	B.J.	F.N.	1:50	NH2UJ-DG-RD-0551	NH2UJ-DG-RD-0551	NH2UJ-DG-RD-0551	TE	B
B	31.01.2013	TRAFIC MANAGEMENT SUBMISSION	SZT	B.J.	F.N.	1:50					
<p>PROJECT: NAMBUCCA AND BELLINGEN SHIRE COUNCILS PACIFIC HIGHWAY UPGRADE NAMBUCCA HEADS TO URUNGA HORIZONTAL & VERTICAL DESIGN TEMPORARY WORKS BURKES LANE</p>											
<p>CLIENT: Transport Infrastructure NSW CONTRACTOR: Abigroup Constructing Australia's Future</p>											
<p>SCALE: 1:2000 ORIGINAL DRAWING SIZE: A1.73 CO-ORDINATE SYSTEM: MGA84 NORTHING: 6830000 EASTING: 683000</p>											

LEGEND

GENERAL

- EXISTING PAVEMENT
- SURVEY
- CADASTRAL (ACCURACY UNKNOWN)
- SITE BOUNDARY (SWTC APP.2)
- SITE BOUNDARY OFFSET (DISTANCE VARIES)
- LOCAL ROAD CORRIDOR BOUNDARY (AS MODIFIED FOR TENDER DESIGN)
- LOCAL ROAD CORRIDOR BOUNDARY (SWTC APP.3)
- AREA OF TEMPORARY PAVEMENTS

NOTES

1. FOR FURTHER DETAIL ON CLEARING EXTENTS REFER DRAWINGS NH2UJ-DG-EV-0001 TO 0048.
2. FOR FURTHER DETAIL ON PROPERTY WORKS REFER DRAWINGS NH2UJ-DG-PA-0001 TO 0125.

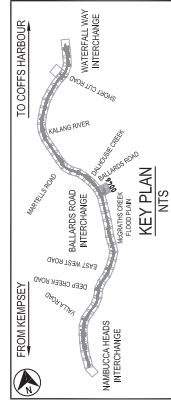
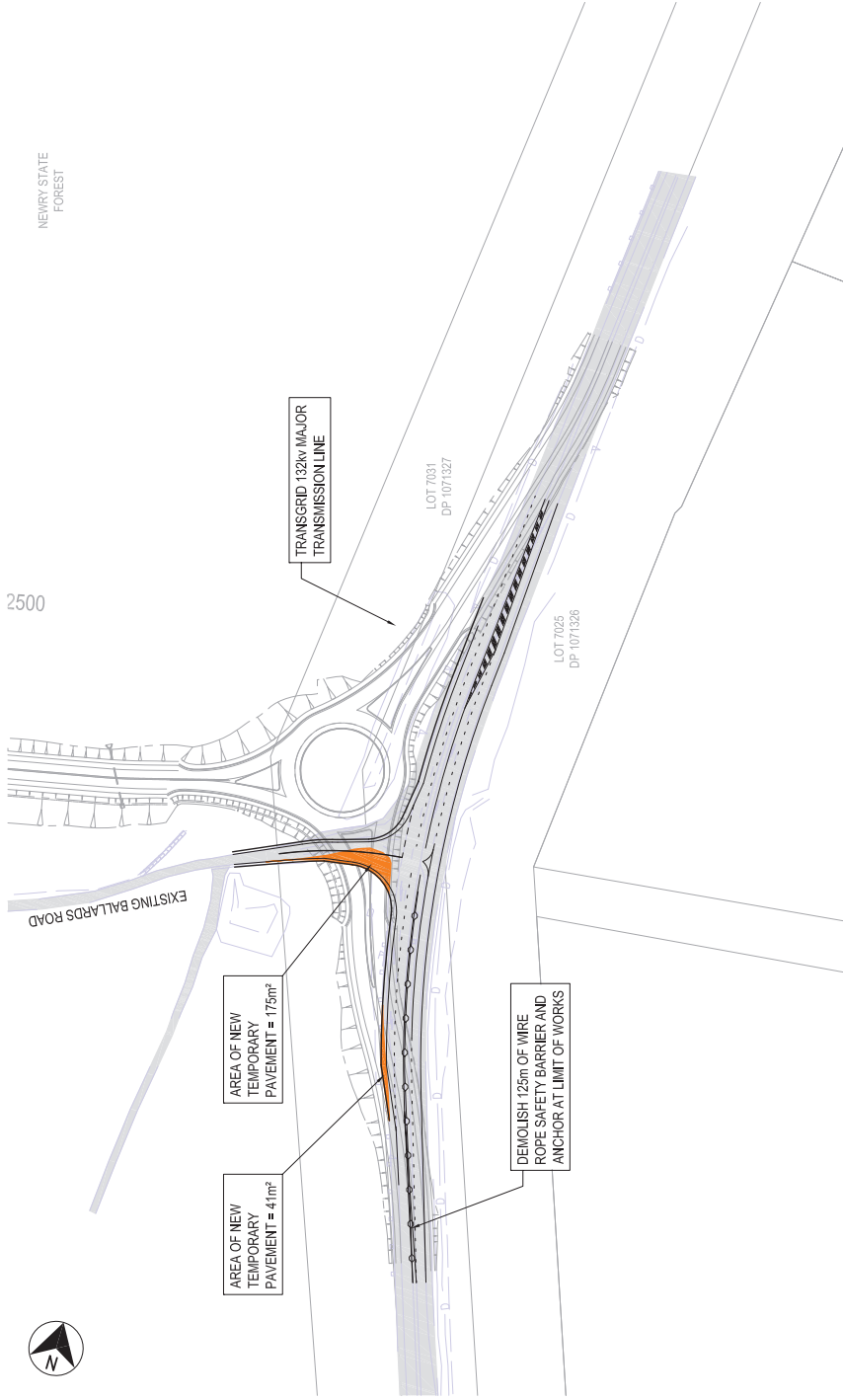

<p>STATUS</p> <p>TMP SUBMISSION</p>		<p>PROJECT</p> <p>NAMBUCCA AND BELLINGEN SHIRE COUNCILS PACIFIC HIGHWAY UPGRADE NAMBUCCA HEADS TO URUNGA HORIZONTAL & VERTICAL DESIGN TEMPORARY WORKS BALLARDS ROAD INTERSECTION</p>		<p>CONTRACTOR</p> <p>Abigroup Constructing Australia's Future</p>		<p>CLIENT</p> <p>Transport Roads & Maritime Services NSW</p>		<p>SCALE</p> <p>SCALE 1:2000</p> <p>1:2000 (AS 1755)</p> <p>1:2000 (AS 1755)</p>		<p>DATE</p> <p>05.08.2012</p>		<p>DATE</p> <p>05.08.2012</p>		<p>DATE</p> <p>05.08.2012</p>	
<p>VOLUME</p> <p>TMP</p>		<p>CONTRACT</p> <p>NH2UJ-DG-RD-0361</p>		<p>CONTRACT</p> <p>NH2UJ-DG-RD-0361</p>		<p>SCALE</p> <p>SCALE 1:2000</p>		<p>DATE</p> <p>05.08.2012</p>		<p>DATE</p> <p>05.08.2012</p>		<p>DATE</p> <p>05.08.2012</p>			
<p>PHASE</p> <p>TE</p>		<p>CONTRACT</p> <p>NH2UJ-DG-RD-0361</p>		<p>CONTRACT</p> <p>NH2UJ-DG-RD-0361</p>		<p>SCALE</p> <p>SCALE 1:2000</p>		<p>DATE</p> <p>05.08.2012</p>		<p>DATE</p> <p>05.08.2012</p>		<p>DATE</p> <p>05.08.2012</p>			
<p>REV</p> <p>B</p>		<p>CONTRACT</p> <p>NH2UJ-DG-RD-0361</p>		<p>CONTRACT</p> <p>NH2UJ-DG-RD-0361</p>		<p>SCALE</p> <p>SCALE 1:2000</p>		<p>DATE</p> <p>05.08.2012</p>		<p>DATE</p> <p>05.08.2012</p>		<p>DATE</p> <p>05.08.2012</p>			