



LEGEND

- SITE BOUNDARY (SWTC APP.2)
- LOCAL ROAD CORRIDOR BOUNDARY (AS MODIFIED FOR TENDER DESIGN)
- LOCAL ROAD CORRIDOR BOUNDARY (SWTC APP.3)
- PACIFIC HIGHWAY UPGRADE
- EXISTING HIGHWAY / LOCAL ROADS
- WORKS CONSTRUCTED OFF LINE
- WORKS CONSTRUCTED UNDER TRAFFIC
- SIDE TRACK / TEMPORARY WORKS / DETOUR
- LIVE TRAFFIC LANES
- COMPLETED WORKS
- REHABILITATION WORKS
- EXISTING PAVEMENT
- TRAFFIC FLOW (BI-DIRECTIONAL U.N.O)



NOTES

1. CONSTRUCTION ACCESS VIA DEEP CREEK ROAD AND EAST WEST ROAD.

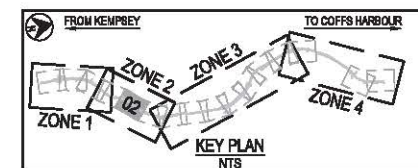

DATE: 31/01/2015 5:41:57 PM, LOGON NAME: INFR, BATCH: (S204)
 LOCAL PATH: \\nsd\projects\stage\p2\dwg\07_Construction_Signage - Temporary - Works\NH2U-DG-TW-0211-0222.dwg

REV	DATE	DESCRIPTION	DRAWN	CHECKED	APPROVED	PROJECT MANAGER
B	31.01.2015	TRAFFIC MANAGEMENT SUBMISSION	S.Z.T.	B.L.	F.N.	
A	05.09.2012	TENDER SUBMISSION	D.L.	N.P.	F.N.	

TITLE	INITIALS	DATE
DRAWN/CHECKER	D.L.	05.09.2012
DRAWN/CHECKER	S.H.	05.09.2012
DRAWN/CHECKER	G.C.	05.09.2012
DRAWN/CHECKER	N.P.	05.09.2012
DRAWN/CHECKER	F.N.	05.09.2012

SCALE 1:5000

 CLIENT: **NSW** Transport Roads & Maritime Services

CONTRACTOR: **Abigroup**
 Constructing Australia's Future

PROJECT: NAMBUCCA AND BELLINGEN SHIRE COUNCILS
 PACIFIC HIGHWAY UPGRADE
 NAMBUCCA HEADS TO URUNGA
 TRAFFIC AND STAGING ARRANGEMENTS
 ZONE 2 - DEEP CREEK ROAD TO BURKES LANE
 SHEET 2 - STAGE 1

PROJECT	TMP SUBMISSION	
VOLUME	DRAWN AND CHECKED/REVISION CONTRACT NO.	
TEMP	TE	
DATE	DRAWING NO.	REV
	NH2U-DG-TW-0215	B

This drawing may have been prepared using colour and may be illegible if copied



LEGEND

- SITE BOUNDARY (SWTC APP.2)
- LOCAL ROAD CORRIDOR BOUNDARY (AS MODIFIED FOR TENDER DESIGN)
- LOCAL ROAD CORRIDOR BOUNDARY (SWTC APP.3)
- PACIFIC HIGHWAY UPGRADE
- EXISTING HIGHWAY / LOCAL ROADS
- WORKS CONSTRUCTED OFF LINE
- WORKS CONSTRUCTED UNDER TRAFFIC
- SIDE TRACK / TEMPORARY WORKS / DETOUR
- LIVE TRAFFIC LANES
- COMPLETED WORKS
- REHABILITATION WORKS
- EXISTING PAVEMENT
- TRAFFIC FLOW (BI-DIRECTIONAL U.N.O)



NOTES

1. CONSTRUCTION ACCESS VIA DEEP CREEK ROAD.

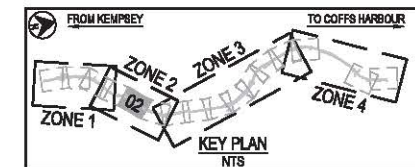

DATE: 31/01/2015 5:41:12 PM, LOGON NAME: INFR, BATCH: (S04)
 LOCATION: I:\Submissions\Stage\2\TM\02\Drawings\Transport\Modelling\2015\TM-02112-0220.dwg

REV	DATE	DESCRIPTION	DRAWN	CHECKED	APPROVED	PROJECT MANAGER
B	31.01.2015	TRAFFIC MANAGEMENT SUBMISSION	S.Z.T.	S.J.	F.N.	
A	05.09.2012	TENDER SUBMISSION	D.L.	N.P.	F.N.	

TITLE	INITIALS	DATE
DRAWN	D.L.	06.08.2012
CHECKED	S.H.	05.08.2012
DESIGNED	G.C.	05.08.2012
ENGINEER	N.P.	05.08.2012
PROJECT MANAGER	F.N.	05.08.2012

Transport Roads & Maritime Services

Abigroup
 Constructing Australia's Future

CLIENT
 TRANSPORT ROADS & MARITIME SERVICES

CONTRACTOR
 ABIGROUP

PROJECT
 NAMBUCCA AND BELLINGEN SHIRE COUNCILS
 PACIFIC HIGHWAY UPGRADE
 NAMBUCCA HEADS TO URUNGA
 TRAFFIC AND STAGING ARRANGEMENTS
 ZONE 2 - DEEP CREEK ROAD TO BURKES LANE
 SHEET 2 - STAGE 2

TMP SUBMISSION	
VOLUME	DESIGN AND CONSTRUCTION CONTRACT NO.
TMP	
FRAME	DRAWINGS
TE	NH2U-DG-TW-0216
REV	B



LEGEND

- SITE BOUNDARY (SWTC APP.2)
- LOCAL ROAD CORRIDOR BOUNDARY (AS MODIFIED FOR TENDER DESIGN)
- LOCAL ROAD CORRIDOR BOUNDARY (SWTC APP.3)
- PACIFIC HIGHWAY UPGRADE
- EXISTING HIGHWAY / LOCAL ROADS
- WORKS CONSTRUCTED OFF LINE
- WORKS CONSTRUCTED UNDER TRAFFIC
- SIDE TRACK / TEMPORARY WORKS / DETOUR
- LIVE TRAFFIC LANES
- COMPLETED WORKS
- REHABILITATION WORKS
- EXISTING PAVEMENT
- TRAFFIC FLOW (BI-DIRECTIONAL U.N.O)

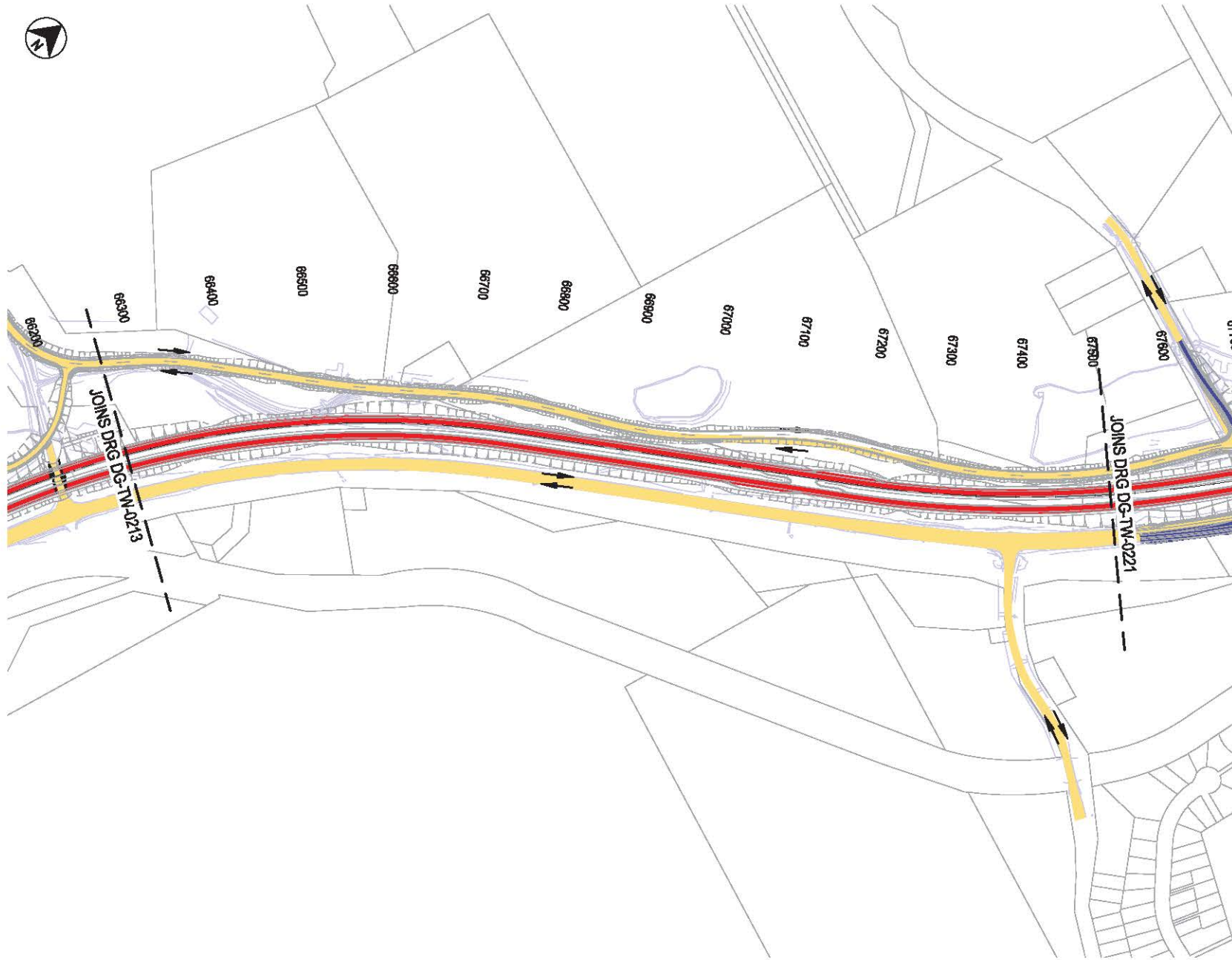

NOTES

1. CONSTRUCTION ACCESS VIA DEEP CREEK ROAD.

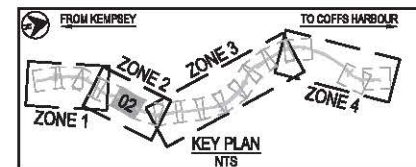

DATE: 31/01/2015 5:41:52 PM, LOGON NAME: INFR, BATCH: (S04)
 LOCAL PATH: I:\Infr\Proposals\1303\Submittals\Stage2\TM\0213\Drawings\Main\NH2U-DG-TW-0213-0222.dwg

REV	DATE	DESCRIPTION	DRAWN	CHECKED	APPROVED	PROJECT MANAGER
B	31.01.2015	TRAFFIC MANAGEMENT SUBMISSION	S.Z.T.	S.L.	F.N.	
A	05.09.2012	TENDER SUBMISSION	D.L.	N.P.	F.N.	

Transport Roads & Maritime Services

Abigroup
 Constructing Australia's Future

CLIENT: **Transport Roads & Maritime Services**
 CONTRACTOR: **Abigroup**

PROJECT: **NAMBUCCA AND BELLINGEN SHIRE COUNCILS
 PACIFIC HIGHWAY UPGRADE
 NAMBUCCA HEADS TO URUNGA
 TRAFFIC AND STAGING ARRANGEMENTS
 ZONE 2 - DEEP CREEK ROAD TO BURKES LANE
 SHEET 2 - STAGE 3**

TMP SUBMISSION	
VOLUME: TMP	DRAWN AND CHECKED/TEAM CONTRACT NO:
FRAME: TE	DRAWING NO: NH2U-DG-TW-0217
REV: B	



LEGEND

- SITE BOUNDARY (SWTC APP.2)
- LOCAL ROAD CORRIDOR BOUNDARY (AS MODIFIED FOR TENDER DESIGN)
- LOCAL ROAD CORRIDOR BOUNDARY (SWTC APP.3)
- PACIFIC HIGHWAY UPGRADE
- EXISTING HIGHWAY / LOCAL ROADS
- WORKS CONSTRUCTED OFF LINE
- WORKS CONSTRUCTED UNDER TRAFFIC
- SIDE TRACK / TEMPORARY WORKS / DETOUR
- LIVE TRAFFIC LANES
- COMPLETED WORKS
- REHABILITATION WORKS
- EXISTING PAVEMENT
- TRAFFIC FLOW (BI-DIRECTIONAL U.N.O)

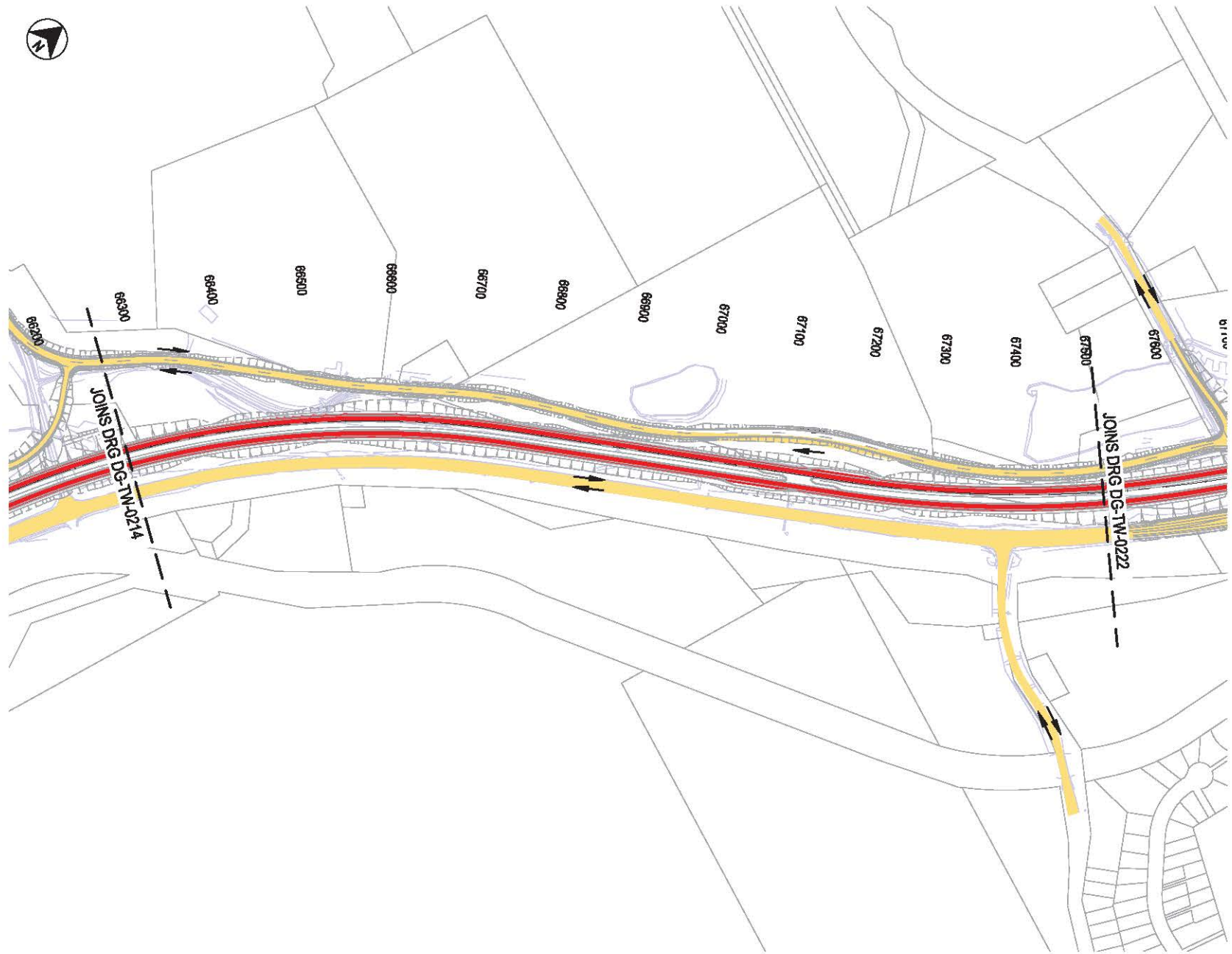

NOTES

1. CONSTRUCTION ACCESS VIA DEEP CREEK ROAD.

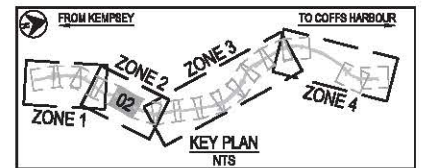

DATE: 31/01/2015 5:41:53 PM, LOGON NAME: INFR, BATCH: (S04)
 LOCALIZATION: I:\Submissions\Stage4\TW-0214\0222\Combinator\Stage4 - Temporary Works\NH2U-DG-TW-0214-0222.dwg

REV	DATE	DESCRIPTION	DRAWN	CHECKED	APPROVED	PROJECT MANAGER
B	31.01.2015	TRAFFIC MANAGEMENT SUBMISSION	S.Z.T.	S.L.	F.N.	
A	05.09.2012	TENDER SUBMISSION	D.L.	N.P.	F.N.	

TITLE	INITIALS	DATE
DRAWN	D.L.	06.08.2012
CHECKED	S.H.	06.08.2012
DESIGNED	G.C.	05.08.2012
ENGINEER	N.P.	06.08.2012
PROJECT MANAGER	F.N.	06.08.2012

SCALE 1:5000	50	0	100	100
COORDINATE SYSTEM: MGA Zone 57		HEIGHT DATUM: AHD		

CLIENT

Transport Roads & Maritime Services

CONTRACTOR

Constructing Australia's Future

PROJECT

NAMBUCCA AND BELLINGEN SHIRE COUNCILS
 PACIFIC HIGHWAY UPGRADE
 NAMBUCCA HEADS TO URUNGA
 TRAFFIC AND STAGING ARRANGEMENTS
 ZONE 2 - DEEP CREEK ROAD TO BURKES LANE
 SHEET 2 - STAGE 4

TMP SUBMISSION	
VOLUME	DISEN AND CONSTRUCTION CONTRACT NO.
TMP	
FRAME	DRAWING NO.
TE	NH2U-DG-TW-0218
REV	B

This drawing may have been prepared using colour and may be illegible if copied



LEGEND

- SITE BOUNDARY (SWTC APP.2)
- LOCAL ROAD CORRIDOR BOUNDARY (AS MODIFIED FOR TENDER DESIGN)
- LOCAL ROAD CORRIDOR BOUNDARY (SWTC APP.3)
- PACIFIC HIGHWAY UPGRADE
- EXISTING HIGHWAY / LOCAL ROADS
- WORKS CONSTRUCTED OFF LINE
- WORKS CONSTRUCTED UNDER TRAFFIC
- SIDE TRACK / TEMPORARY WORKS / DETOUR
- LIVE TRAFFIC LANES
- COMPLETED WORKS
- REHABILITATION WORKS
- EXISTING PAVEMENT
- TRAFFIC FLOW (BI-DIRECTIONAL U.N.D)

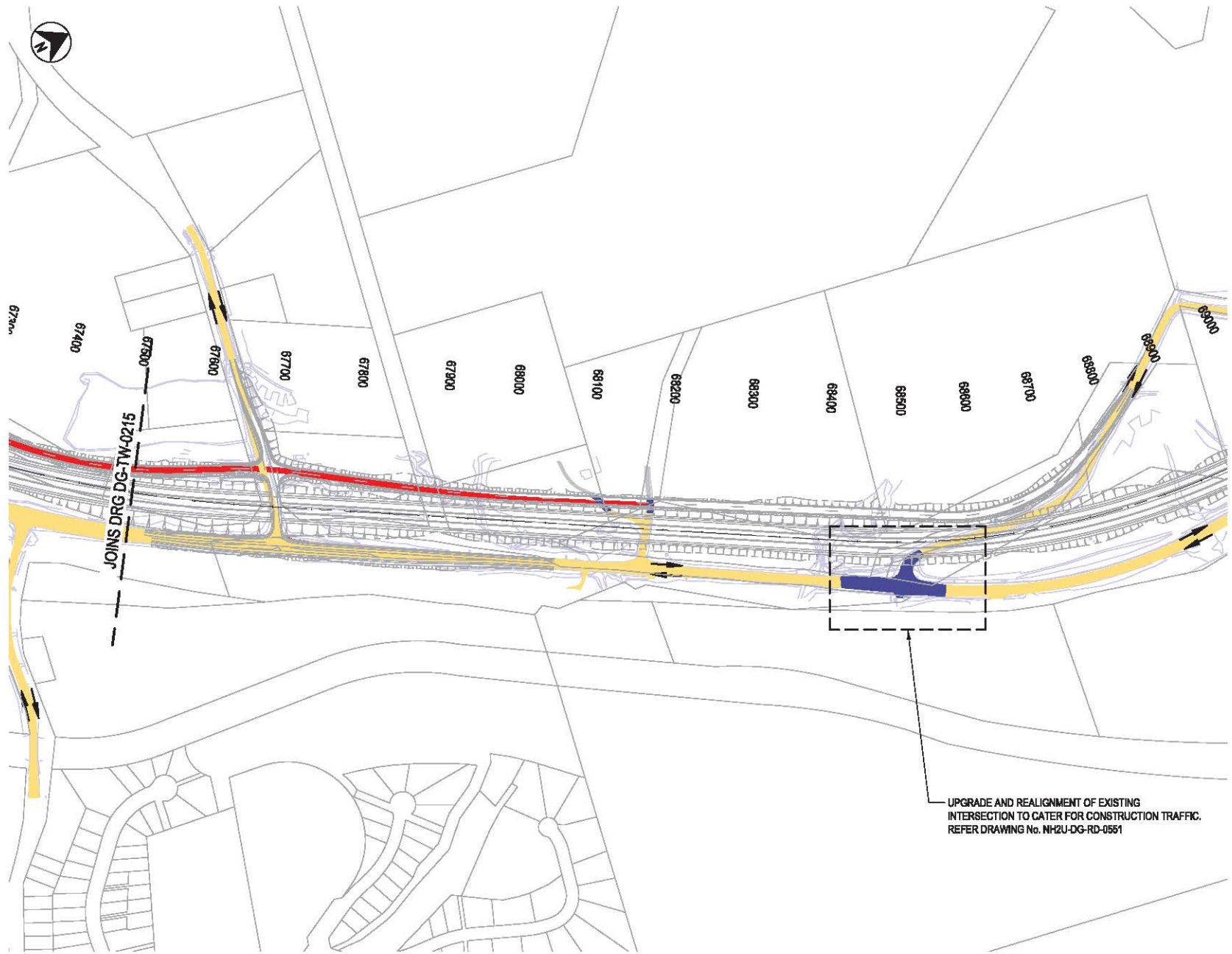

JOINS DRG DG-TW-0215

UPGRADE AND REALIGNMENT OF EXISTING INTERSECTION TO CATER FOR CONSTRUCTION TRAFFIC. REFER DRAWING No. NH2U-DG-RD-0551

- NOTES**
1. THE PROJECT DEED PREVENTS CONSTRUCTION OF ACCESS ROAD D TO BURKE LANE UNTIL 1st JANUARY 2014. ACCESS TO BURKES LANE HAS BEEN ASSUMED FOR STAGE 2 WORKS AND LOCAL ACCESS ROAD D WILL BE CONSTRUCTED UP TO BURKES LANE DURING THIS STAGE.
 2. CONSTRUCTION ACCESS VIA EAST WEST ROAD

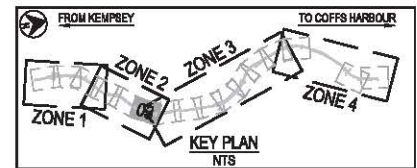

DATE: 31.01.2013 5:41:56 PM LOGIN NAME: INFR_BATCH (8264)
 LOCAL PATH: I:\Infr\Proposals\1303\Submissions\Stage2\Infr\DWG\07_Combination_Signage - Temporary_Moche\NH2U-DG-TW-0215-0222.dwg

REV	DATE	DESCRIPTION	DRAWN	CHECKED	APPROVED	PROJECT MANAGER
B	31.01.2013	TRAFFIC MANAGEMENT SUBMISSION	S.Z.T.	S.L.	F.N.	
A	05.09.2012	TENDER SUBMISSION	D.L.	N.P.	F.N.	

CLIENT

Transport
Roads & Maritime
Services

CONTRACTOR

Abigroup
Constructing Australia's Future

PROJECT

NAMBUCCA AND BELLINGEN SHIRE COUNCILS
PACIFIC HIGHWAY UPGRADE
NAMBUCCA HEADS TO URUNGA
TRAFFIC AND STAGING ARRANGEMENTS
ZONE 2 - DEEP CREEK ROAD TO BURKES LANE
SHEET 3 - STAGE 1

OTHER

TMP SUBMISSION

VEHICLE	DRIVEN AND CONSTRUCTION CONTRACT NO.
TMP	
FRAME	DRAWINGS
TE	NH2U-DG-TW-0219
REV	B

1:10 1:20 1:50 2:50 mm ON A3 ORIGINAL This Drawing may have been prepared using colour and may be illegible if copied



LEGEND

- SITE BOUNDARY (SWTC APP.2)
- LOCAL ROAD CORRIDOR BOUNDARY (AS MODIFIED FOR TENDER DESIGN)
- LOCAL ROAD CORRIDOR BOUNDARY (SWTC APP.3)
- PACIFIC HIGHWAY UPGRADE
- EXISTING HIGHWAY / LOCAL ROADS
- WORKS CONSTRUCTED OFF LINE
- WORKS CONSTRUCTED UNDER TRAFFIC
- SIDE TRACK / TEMPORARY WORKS / DETOUR
- LIVE TRAFFIC LANES
- COMPLETED WORKS
- REHABILITATION WORKS
- EXISTING PAVEMENT
- TRAFFIC FLOW (BI-DIRECTIONAL U.N.D)

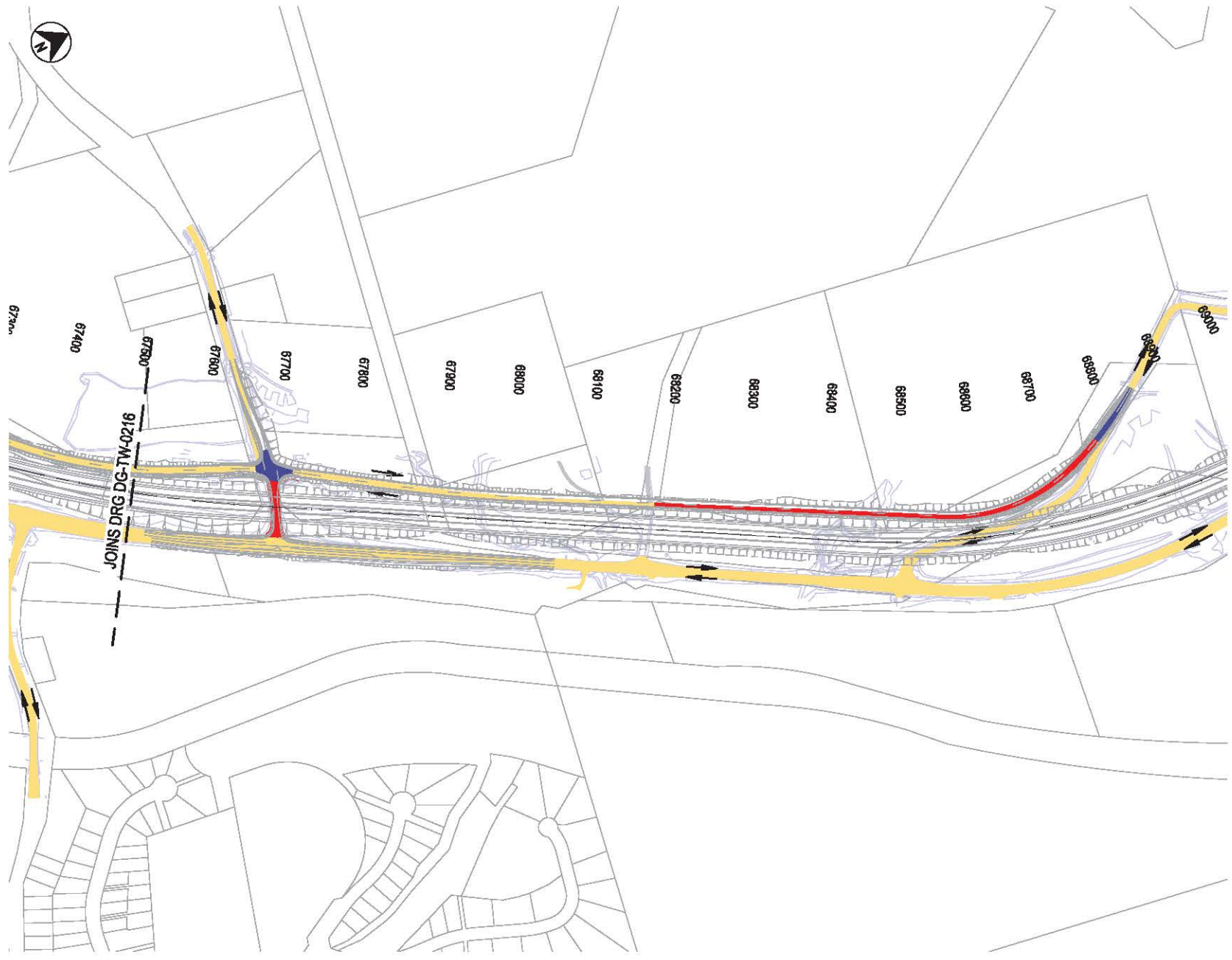

NOTES

1. THE PROJECT DEED PREVENTS CONSTRUCTION OF ACCESS ROAD D TO BURKE LANE UNTIL 1st JANUARY 2014. ACCESS TO BURKE LANE HAS BEEN ASSUMED FOR STAGE 2 WORKS AND LOCAL ACCESS ROAD D WILL BE CONSTRUCTED UP TO BURKE LANE DURING THIS STAGE.
2. CONSTRUCTION ACCESS VIA BURKE LANE OR DEEP CREEK ROAD.

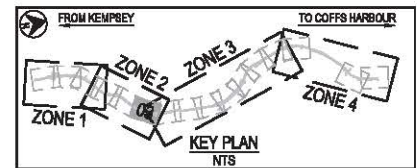

DATE: 31/01/2013 5:42:27 PM LOGON NAME: INFR_BATCH (8264)
 LOCATION: I:\Submissions\Stage2\DC-TW-0216\Drawings\Temp\Work\NH2U-DG-TW-0216-0222.dwg

REV	DATE	DESCRIPTION	DRAWN	CHECKED	APPROVED	PROJECT MANAGER
B	31.01.2013	TRAFFIC MANAGEMENT SUBMISSION	S.Z.T.	S.L.	F.N.	
A	05.09.2012	TENDER SUBMISSION	D.L.	N.P.	F.N.	

TITLE	INITIALS	DATE
DRAWN	D.L.	06.08.2012
CHECKED	S.H.	06.08.2012
DESIGNED	G.C.	05.08.2012
ENGINEER	N.P.	06.08.2012
PROJECT MANAGER	F.N.	06.08.2012
APPROVED	K.L.	06.08.2012

ORIGINAL DRAWING AT A3 SIZE	SCALE 1:5000	COORDINATE SYSTEM: MGA Zone 57	HEIGHT DATUM: AHD
-----------------------------	--------------	--------------------------------	-------------------

CLIENT: **Transport Roads & Maritime Services**

CONTRACTOR: **Abigroup**
Constructing Australia's Future

PROJECT: **NAMBUCCA AND BELLINGEN SHIRE COUNCILS PACIFIC HIGHWAY UPGRADE**
NAMBUCCA HEADS TO URUNGA TRAFFIC AND STAGING ARRANGEMENTS
ZONE 2 - DEEP CREEK ROAD TO BURKE LANE
SHEET 3 - STAGE 2

TMP SUBMISSION	
VEHICLE: TMP	OWNER AND CONSTRUCTION CONTRACT NO:
FRAME: TE	DRAWING NO: NH2U-DG-TW-0220
REV: B	

This drawing may have been prepared using colour and may be illegible if copied



LEGEND

- SITE BOUNDARY (SWTC APP.2)
- LOCAL ROAD CORRIDOR BOUNDARY (AS MODIFIED FOR TENDER DESIGN)
- LOCAL ROAD CORRIDOR BOUNDARY (SWTC APP.3)
- PACIFIC HIGHWAY UPGRADE
- EXISTING HIGHWAY / LOCAL ROADS
- WORKS CONSTRUCTED OFF LINE
- WORKS CONSTRUCTED UNDER TRAFFIC
- SIDE TRACK / TEMPORARY WORKS / DETOUR
- LIVE TRAFFIC LANES
- COMPLETED WORKS
- REHABILITATION WORKS
- EXISTING PAVEMENT
- TRAFFIC FLOW (BI-DIRECTIONAL U.N.D)

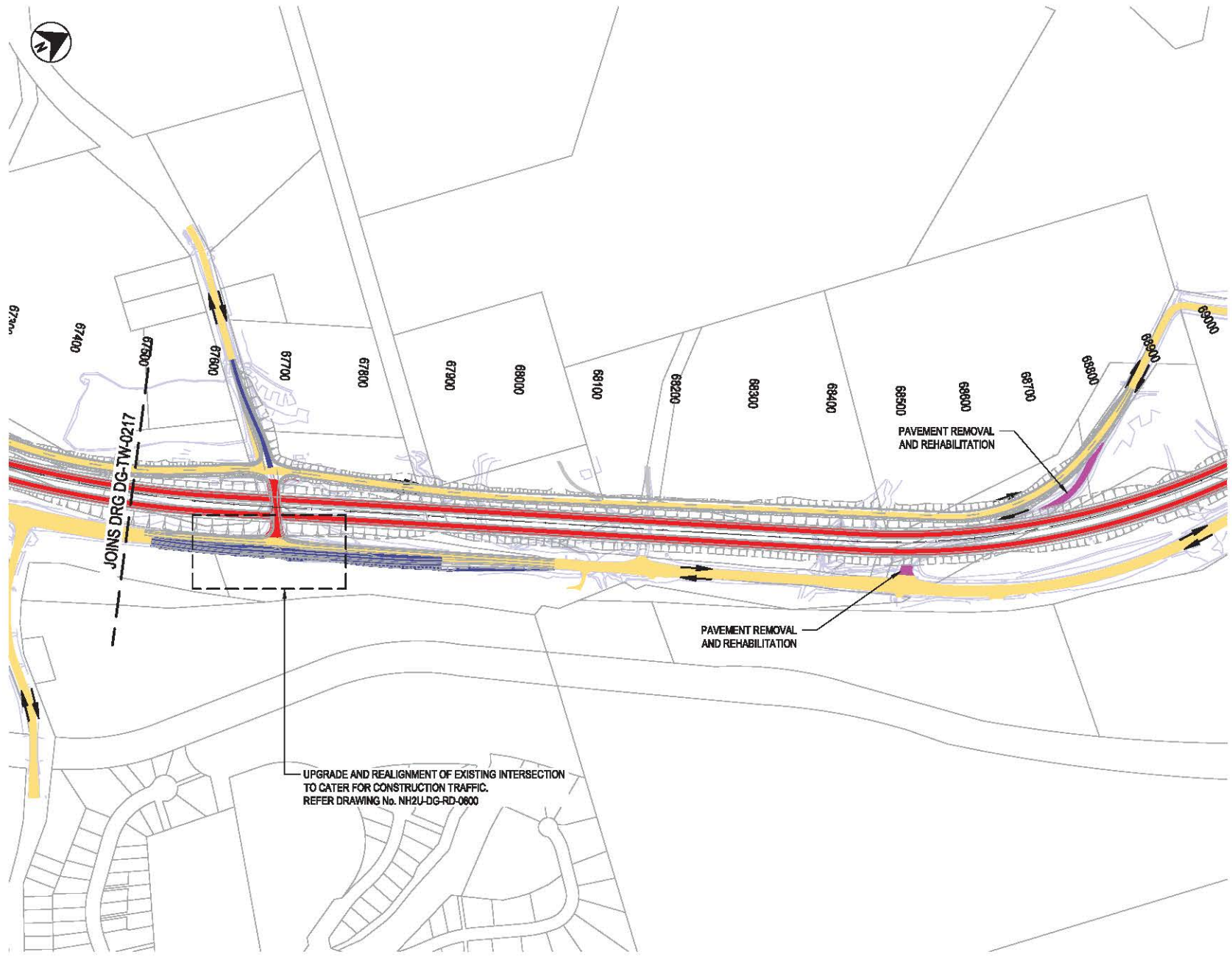

NOTES
 1. CONSTRUCTION ACCESS VIA BURKES LANE OR DEEP CREEK ROAD.

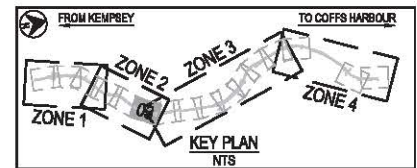

DATE: 31.01.2013 9:42:20 PM LOGON NAME: INFR_BATCH (8264)
 LOCAL PATH: I:\NH2U\NH2U-DG-TW-0217\Drawings\Stage 3 - Temporary Works\NH2U-DG-TW-0217-0222.dwg

REV	DATE	DESCRIPTION	DRAWN	CHECKED	APPROVED
B	31.01.2013	TRAFFIC MANAGEMENT SUBMISSION	S.Z.T.	S.L.	F.N.
A	05.09.2012	TENDER SUBMISSION	D.L.	N.P.	F.N.

TITLE	INITIALS	DATE
DRAWN	D.L.	06.08.2012
CHECKED	S.H.	06.08.2012
DESIGNED	G.C.	05.08.2012
ENGINEER	N.P.	06.08.2012
PROJECT MANAGER	F.N.	06.08.2012
PROJECT MANAGER	K.L.	06.08.2012

ORIGINAL DRAWING AT A3 SIZE

SCALE 1:5000

COORDINATE SYSTEM: MGA Zone 57 HEIGHT DATUM: AHD

CLIENT

Transport
Roads & Maritime
Services

CONTRACTOR

Abigroup
Constructing Australia's Future

PROJECT

NAMBUCCA AND BELLINGEN SHIRE COUNCILS
 PACIFIC HIGHWAY UPGRADE
 NAMBUCCA HEADS TO URUNGA
 TRAFFIC AND STAGING ARRANGEMENTS
 ZONE 2 - DEEP CREEK ROAD TO BURKES LANE
 SHEET 3 - STAGE 3

DRAWING		REV
TMP SUBMISSION		
SCALE	DRAWN AND CHECKED/REVISION CONTRACT NO.	
TMP	TE	REV
	NH2U-DG-TW-0221	B

This drawing may have been prepared using colour and may be illegible if copied.



LEGEND

- SITE BOUNDARY (SWTC APP.2)
- LOCAL ROAD CORRIDOR BOUNDARY (AS MODIFIED FOR TENDER DESIGN)
- LOCAL ROAD CORRIDOR BOUNDARY (SWTC APP.3)
- PACIFIC HIGHWAY UPGRADE
- EXISTING HIGHWAY / LOCAL ROADS
- WORKS CONSTRUCTED OFF LINE
- WORKS CONSTRUCTED UNDER TRAFFIC
- SIDE TRACK / TEMPORARY WORKS / DETOUR
- LIVE TRAFFIC LANES
- COMPLETED WORKS
- REHABILITATION WORKS
- EXISTING PAVEMENT
- TRAFFIC FLOW (BI-DIRECTIONAL U.N.D)

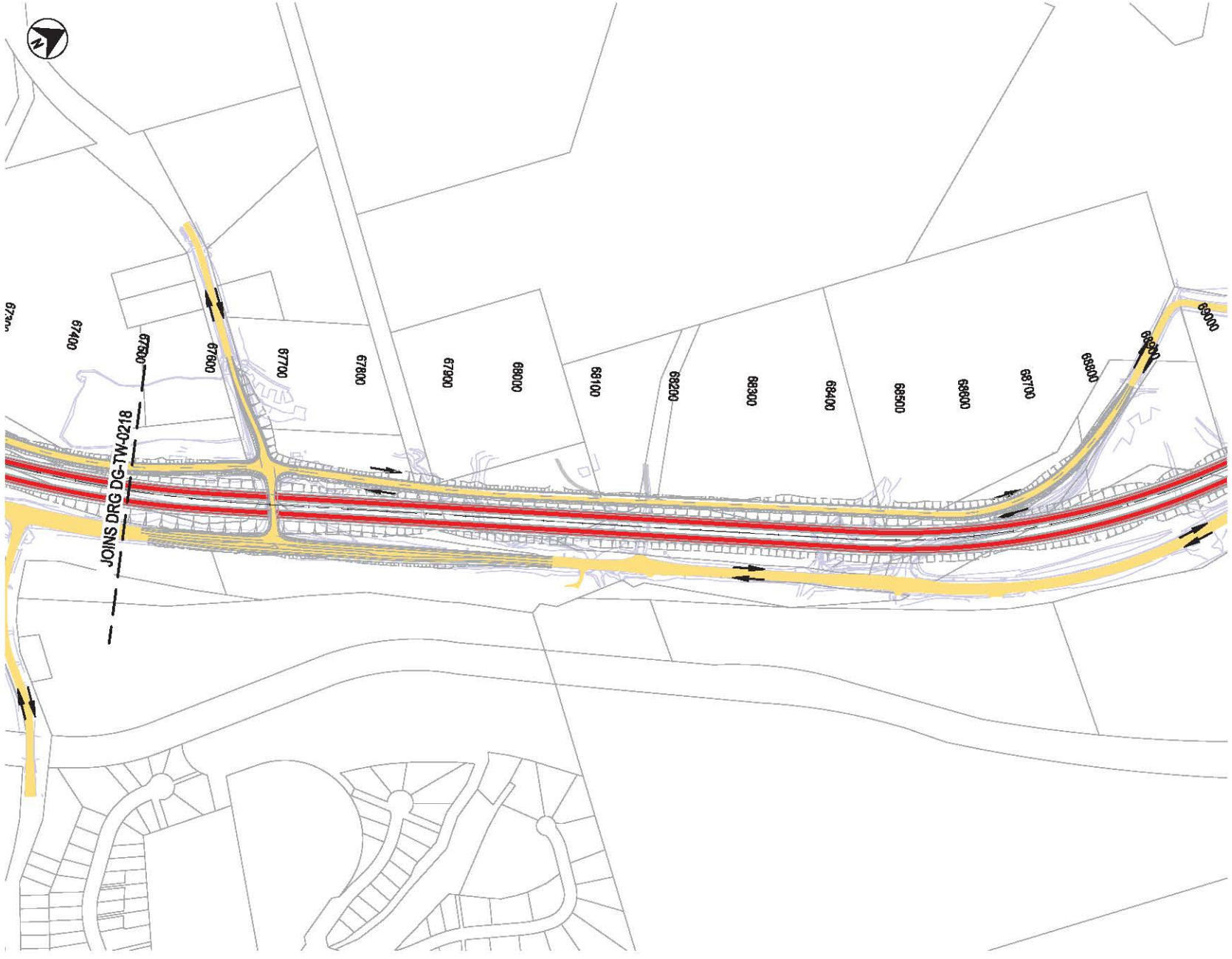

NOTES

1. CONSTRUCTION ACCESS VIA BURKES LANE OR DEEP CREEK ROAD.

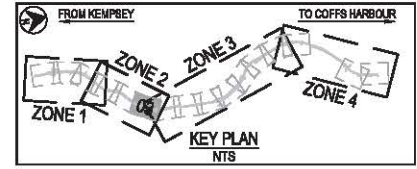

DATE: 31.01.2013 5:42:28 PM LOGON NAME: INFR_BATCH (8264)
 LOCATION: I:\Submissions\Stage3\Infr\DWG\07 Construction Stage 3 - Temporary Works\NH2U-DG-TW-0218-0222.dwg

REV	DATE	DESCRIPTION	DRAWN	CHECKED	APPROVED	PROJECT MANAGER
B	31.01.2013	TRAFFIC MANAGEMENT SUBMISSION	S.Z.T.	S.L.	F.N.	
A	05.09.2012	TENDER SUBMISSION	D.L.	N.P.	F.N.	

Transport Roads & Maritime Services

Abigroup
 Constructing Australia's Future

PROJECT
 NAMBUCCA AND BELLINGEN SHIRE COUNCILS
 PACIFIC HIGHWAY UPGRADE
 NAMBUCCA HEADS TO URUNGA
 TRAFFIC AND STAGING ARRANGEMENTS
 ZONE 2 - DEEP CREEK ROAD TO BURKES LANE
 SHEET 3 - STAGE 4

TMP SUBMISSION	
VOLUME: TMP FRAME: TE	DESIGN AND CONSTRUCTION CONTRACT NO: DRAWING NO: NH2U-DG-TW-0222
REV	B

This drawing may have been prepared using colour and may be illegible if copied.



- LEGEND**
- SITE BOUNDARY (SWTC APP.2)
 - LOCAL ROAD CORRIDOR BOUNDARY (AS MODIFIED FOR TENDER DESIGN)
 - LOCAL ROAD CORRIDOR BOUNDARY (SWTC APP.3)
 - PACIFIC HIGHWAY UPGRADE
 - EXISTING HIGHWAY / LOCAL ROADS
 - WORKS CONSTRUCTED OFF LINE
 - WORKS CONSTRUCTED UNDER TRAFFIC
 - SIDE TRACK / TEMPORARY WORKS / DETOUR
 - LIVE TRAFFIC LANES
 - COMPLETED WORKS
 - REHABILITATION WORKS
 - EXISTING PAVEMENT
 - TRAFFIC FLOW (BI-DIRECTIONAL U.N.O)

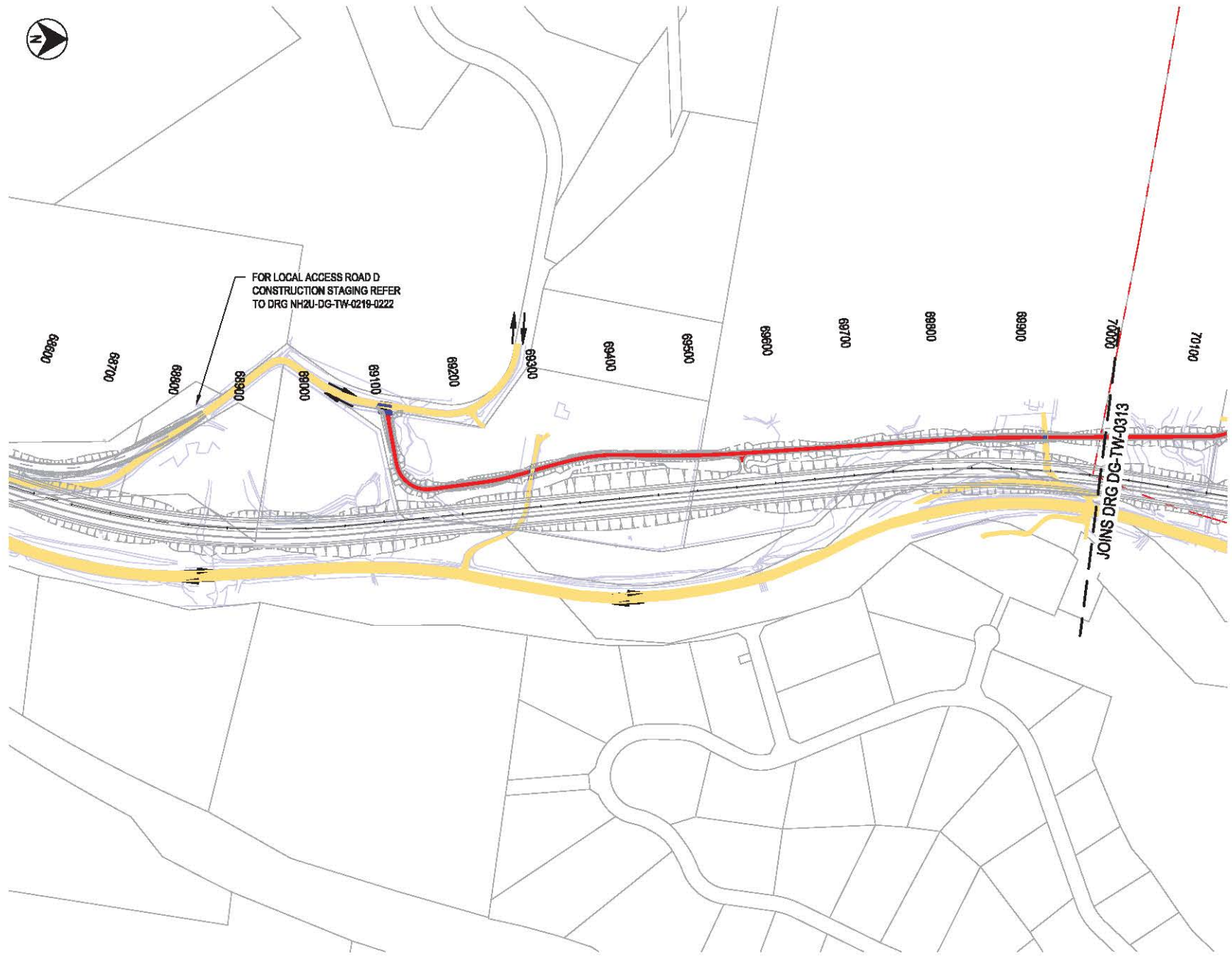

1. CONSTRUCTION ACCESS VIA BURKES LANE.

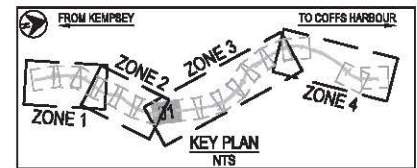

DATE: 31/01/2013 5:43:07 PM LOGIN NAME: INFR_BATCH (804) C:\projects\1303\submittals\NH2U-DG-TW-0313\Drawings - Transport\Work\NH2U-DG-TW-0313_0228.dwg

REV	DATE	DESCRIPTION	BY	CHKD	APPV	TITLE	INITIALS	DATE
B	31.01.2013	TRAFFIC MANAGEMENT SUBMISSION	S.Z.T.	B.L.	F.N.			
A	05.08.2012	TENDER SUBMISSION	D.L.	N.P.	F.N.			
REV	DATE	DESCRIPTION	DRAWN	REVIEWED	APPROVAL	PROJECT MANAGER	DESIGN MANAGER	DATE
						K.L.	F.N.	05.08.2012

CLIENT
Transport Roads & Maritime Services

CONTRACTOR
Abigroup
 Constructing Australia's Future

PROJECT
 NAMBUCCA AND BELLINGEN SHIRE COUNCILS
 PACIFIC HIGHWAY UPGRADE
 NAMBUCCA HEADS TO URUNGA
 TRAFFIC AND STAGING ARRANGEMENTS
 ZONE 3 - BURKES LANE TO KALANG RIVER
 SHEET 1 - STAGE 1

STAGE TMP SUBMISSION	
VEHICLE TMP	DESIGN AND CONSTRUCTION CONTRACT NO.
FRAME TE	DRAWINGS NH2U-DG-TW-0311
REV B	



FROM KEMPSEY

TO COFFS HARBOUR

NAMBUCCA HEADS SHIRE BELLINGEN SHIRE

LOCAL ACCESS ROAD E

FOR LOCAL ACCESS ROAD D CONSTRUCTION STAGING REFER TO DRG NH2U-DG-TW-0219-0222

BURKES LANE

JOINS DRG DG-TW-0314

EXISTING PACIFIC HIGHWAY

LEGEND

- SITE BOUNDARY (SWTC APP.2)
- LOCAL ROAD CORRIDOR BOUNDARY (AS MODIFIED FOR TENDER DESIGN)
- LOCAL ROAD CORRIDOR BOUNDARY (SWTC APP.3)
- PACIFIC HIGHWAY UPGRADE
- EXISTING HIGHWAY / LOCAL ROADS
- WORKS CONSTRUCTED OFF LINE
- WORKS CONSTRUCTED UNDER TRAFFIC
- SIDE TRACK / TEMPORARY WORKS / DETOUR
- LIVE TRAFFIC LANES
- COMPLETED WORKS
- REHABILITATION WORKS
- EXISTING PAVEMENT
- TRAFFIC FLOW (BI-DIRECTIONAL U.N.O)

1. CONSTRUCTION ACCESS VIA BURKES LANE OR BALLARDS ROAD.

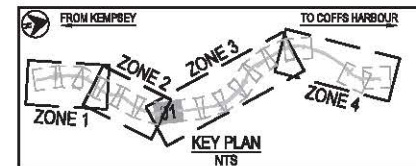

DATE: 05/08/2012 11:02:47 AM LOGON NAME: HALLIBURTON, JAY (684) LOCAL PATH: I:\2012\Projects\NH2U-DG-TW-0314\Drawings\Construction\Stage 1 - Temporary Works\NH2U-DG-TW-0314-0228.dwg

REV	DATE	DESCRIPTION	DRAWN	CHECKED	APPROVED	PROJECT MANAGER
B	31.01.2013	TRAFFIC MANAGEMENT SUBMISSION	S.Z.T.	S.L.	F.N.	
A	05.08.2012	TENDER SUBMISSION	D.L.	N.P.	F.N.	

CLIENT

Transport Roads & Maritime Services

CONTRACTOR

Constructing Australia's Future

PROJECT

NAMBUCCA AND BELLINGEN SHIRE COUNCILS
PACIFIC HIGHWAY UPGRADE
NAMBUCCA HEADS TO URUNGA
TRAFFIC AND STAGING ARRANGEMENTS
ZONE 3 - BURKES LANE TO KALANG RIVER
SHEET 1 - STAGE 2

DRAWING		REV
TMP SUBMISSION		
SCALE	DRAWN AND CHECKED/TEAM CONTRACT NO.	
TMP		
FRAME	DRAWING NO.	REV
TE	NH2U-DG-TW-0312	B