









LEGEND

GENERAL

-  EXISTING PAVEMENT
-  SURVEY
-  CADASTRAL (ACCURACY UNKNOWN)
-  SITE BOUNDARY (SWTC APP.2)
-  SITE BOUNDARY OFFSET (DISTANCE VARIES)
-  LOCAL ROAD CORRIDOR BOUNDARY (AS MODIFIED FOR TENDER DESIGN)
-  LOCAL ROAD CORRIDOR BOUNDARY (SWTC APP.3)
-  AREA OF TEMPORARY PAVEMENTS

NOTES

1. FOR FURTHER DETAIL ON CLEARING EXTENTS REFER DRAWINGS NH2U-DG-EV-0001 TO 0048.
2. FOR FURTHER DETAIL ON PROPERTY WORKS REFER DRAWINGS NH2U-DG-PA-0001 TO 0125.
3. LINEMARKING EXERCISE. NO TEMPORARY PAVEMENT REQUIRED



EXTENT OF PACIFIC HIGHWAY WORKS APPROX 630m NORTH-WEST

DEVIATE SOUTHBOUND LANE TO NEAR-SIDE LANE

SHORTEN EXISTING MEDIAN BY 14m, PLACE INFILL PAVEMENT AND LINEMARK

170m ACCELERATION DISTANCE

EXISTING PACIFIC HIGHWAY

SHORT CUT ROAD

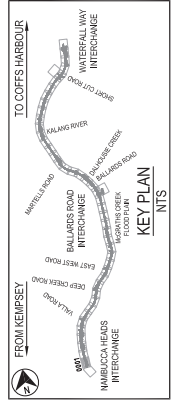

REV		DATE	DESCRIPTION	BY	CHKD	APP'D	DATE	ORIGINAL DRAWING TITLE	SCALE	CAD/DATE SYSTEM/SCALE	HEAT/SCALE/4XD	CONTRACTOR		PROJECT	STATUS		
A	05.08.2012	TRAFIC MANAGEMENT SUBMISSION	S.2.1	B.J.	F.N.	SKRMANAWAGER	E.D.	05.08.2012	AL 73	COORDINATE SYSTEM/SCALE/4XD	HEAT/SCALE/4XD	Transport Roads & Maritime Services NSW	Abigroup Constructing Australia's Future	NAMBUCCA AND BELLINGEN SHIRE COUNCILS PACIFIC HIGHWAY UPGRADE NAMBUCCA HEADS TO URUNGA HORIZONTAL & VERTICAL DESIGN TEMPORARY WORKS SHORT CUT ROAD INTERSECTION	TMP	TMP SUBMISSION	DESIGN AND CONSTRUCTION CONTRACT
B	31.01.2013	TRAFIC MANAGEMENT SUBMISSION	S.2.1	B.J.	F.N.	SKRMANAWAGER	E.D.	05.08.2012	AL 73	COORDINATE SYSTEM/SCALE/4XD	HEAT/SCALE/4XD	Transport Roads & Maritime Services NSW	Abigroup Constructing Australia's Future	NAMBUCCA AND BELLINGEN SHIRE COUNCILS PACIFIC HIGHWAY UPGRADE NAMBUCCA HEADS TO URUNGA HORIZONTAL & VERTICAL DESIGN TEMPORARY WORKS SHORT CUT ROAD INTERSECTION	TE	TE	DESIGN AND CONSTRUCTION CONTRACT



LEGEND

GENERAL

- EXISTING PAVEMENT
- SURVEY
- CADASTRAL (ACCURACY UNKNOWN)
- SITE BOUNDARY (SWTC APP.2)
- SITE BOUNDARY OFFSET (DISTANCE VARIES)
- LOCAL ROAD CORRIDOR BOUNDARY (AS MODIFIED FOR TENDER DESIGN)
- LOCAL ROAD CORRIDOR BOUNDARY (SWTC APP.3)
- AREA OF TEMPORARY PAVEMENTS

NOTES

1. FOR FURTHER DETAIL ON CLEARING EXTENTS REFER DRAWINGS NH2U-DG-EV-0001 TO 0048.
2. FOR FURTHER DETAIL ON PROPERTY WORKS REFER DRAWINGS NH2U-DG-PA-0001 TO 0125.

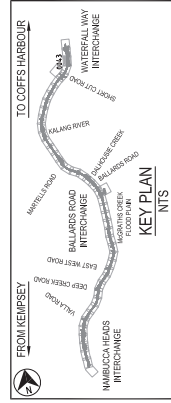
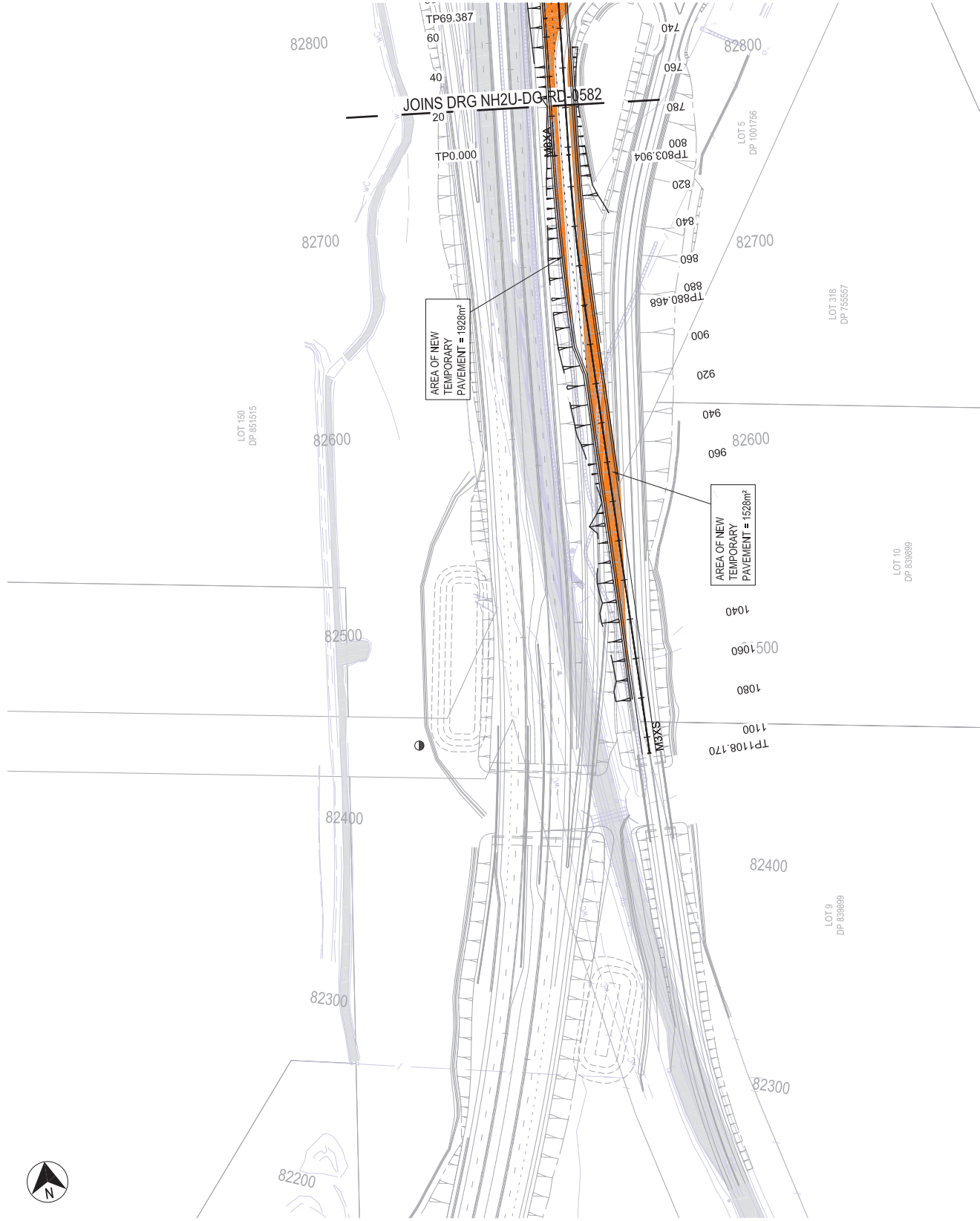

 Constructing Australia's Future		 Constructing Australia's Future		PROJECT NAMBUCCA AND BELLINGEN SHIRE COUNCILS PACIFIC HIGHWAY UPGRADE NAMBUCCA HEADS TO URUNGA HORIZONTAL & VERTICAL DESIGN TEMPORARY WORKS WATERFALL WAY INTERCHANGE SWITCH - SHEET 1		STATUS TMP SUBMISSION	
						REFERENCE CONTRACT CONTRACT NO.	
CONTRACTOR		CLIENT		ORIGINAL DRAWING TITLE SCALE 1:2000 DATE: 05/08/2012 DATE: 05/08/2012 DATE: 05/08/2012 DATE: 05/08/2012 DATE: 05/08/2012 DATE: 05/08/2012 DATE: 05/08/2012		VOLUME TE	
						TITLE TEMPORARY PAVEMENT	
DRAWN BY TE		CHECKED BY TE		PROJECT MANAGER TE		REV B	
DATE 05/08/2012		DATE 05/08/2012		DATE 05/08/2012		DATE 05/08/2012	

LEGEND

- EXISTING PAVEMENT
- SURVEY
- CADASTRAL (ACCURACY UNKNOWN)
- SITE BOUNDARY (SWTC APP.2)
- SITE BOUNDARY OFFSET (DISTANCE VARIES)
- LOCAL ROAD CORRIDOR BOUNDARY (AS MODIFIED FOR TENDER DESIGN)
- LOCAL ROAD CORRIDOR BOUNDARY (SWTC APP.3)
- AREA OF TEMPORARY PAVEMENTS

NOTES

- FOR FURTHER DETAIL ON CLEARING EXTENTS REFER DRAWINGS NH2U-DG-EV-0001 TO 0048.
- FOR FURTHER DETAIL ON PROPERTY WORKS REFER DRAWINGS NH2U-DG-PA-0001 TO 0125.

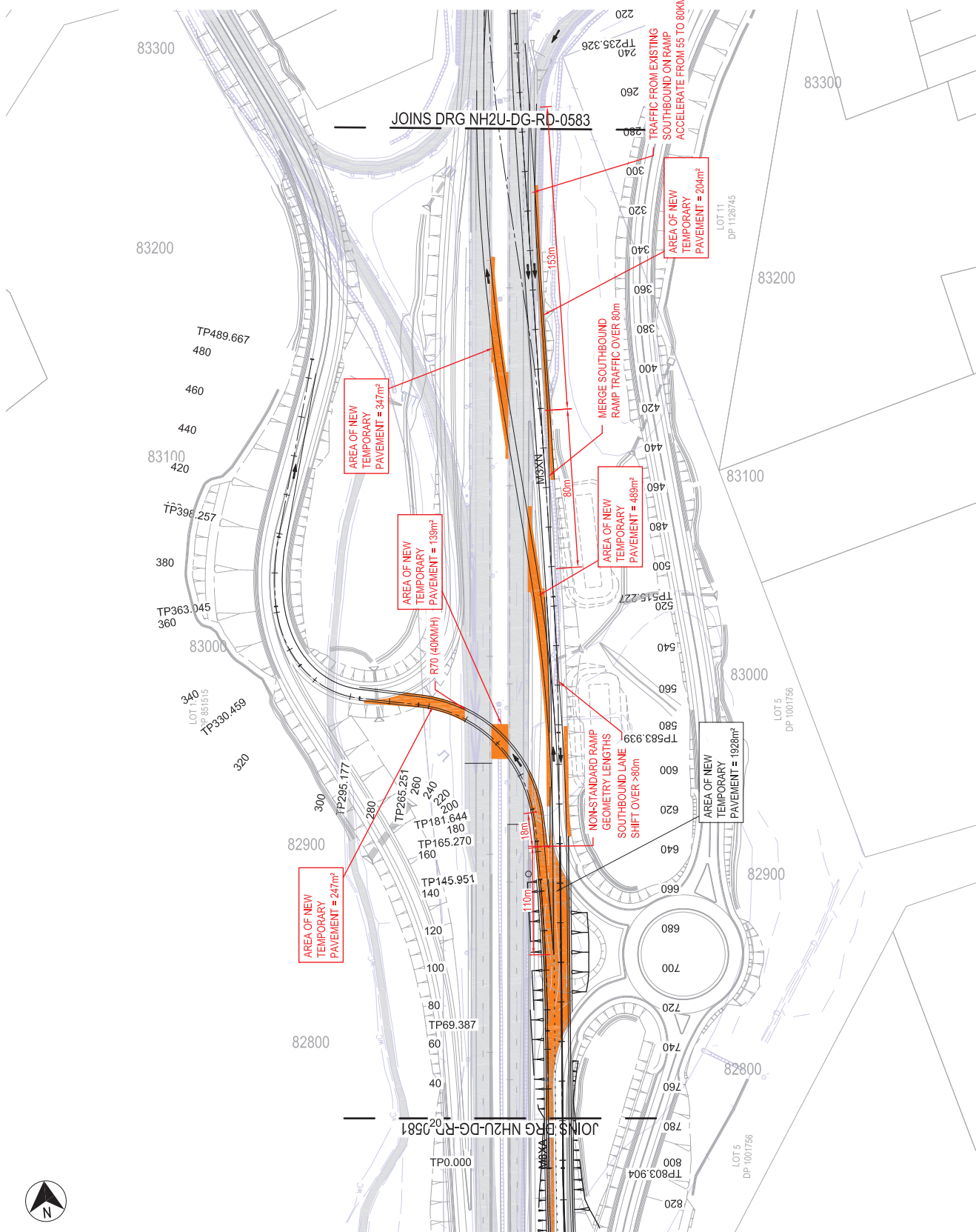
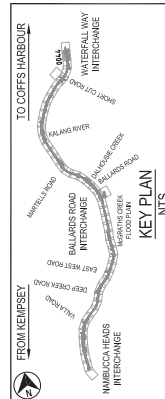

PROJECT		NAMBURCA AND BELLINGEN SHIRE COUNCILS PACIFIC HIGHWAY UPGRADE NAMBURCA HEADS TO URUNGA HORIZONTAL & VERTICAL DESIGN TEMPORARY WORKS WATERFALL WAY INTERCHANGE SWITCH - SHEET 2	
CONTRACTOR		Abigroup Constructing Australia's Future	
CLIENT		Transport Roads & Maritime Services NSW	

STATUS		TMP SUBMISSION	
VOLUME		GENERAL CONTRACT CONTRACT N	
TEMP		TEMP	
PHASE		TE	
REV		C	
DRAWN BY		NH2U-DG-RD-0582	

TITLE	DATE	INITIALS
DESIGNER	31.01.2012	[Signature]
CHECKED	05.02.2012	[Signature]
APPROVED	05.02.2012	[Signature]

DATE	BY	REVISION
31.01.2012	A	TRAFIC MANAGEMENT SUBMISSION
05.02.2012	B	POST TENDER CLARIFICATION A/B/C/D/E/F
05.02.2012	A	TENDER SUBMISSION

This Drawing may have been prepared using a computer plotting system.

LEGEND

GENERAL

- EXISTING PAVEMENT
- SURVEY
- CADASTRAL (ACCURACY UNKNOWN)
- SITE BOUNDARY (SWTC APP.2)
- SITE BOUNDARY OFFSET (DISTANCE VARIES)
- LOCAL ROAD CORRIDOR BOUNDARY (AS MODIFIED FOR TENDER DESIGN)
- LOCAL ROAD CORRIDOR BOUNDARY (SWTC APP.3)
- AREA OF TEMPORARY PAVEMENTS

NOTES

1. FOR FURTHER DETAIL ON CLEARING EXTENTS REFER DRAWINGS NH2UJ-DG-EV-0001 TO 0048.
2. FOR FURTHER DETAIL ON PROPERTY WORKS REFER DRAWINGS NH2UJ-DG-PA-0001 TO 0125.

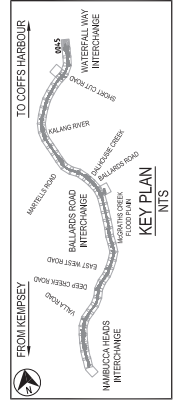
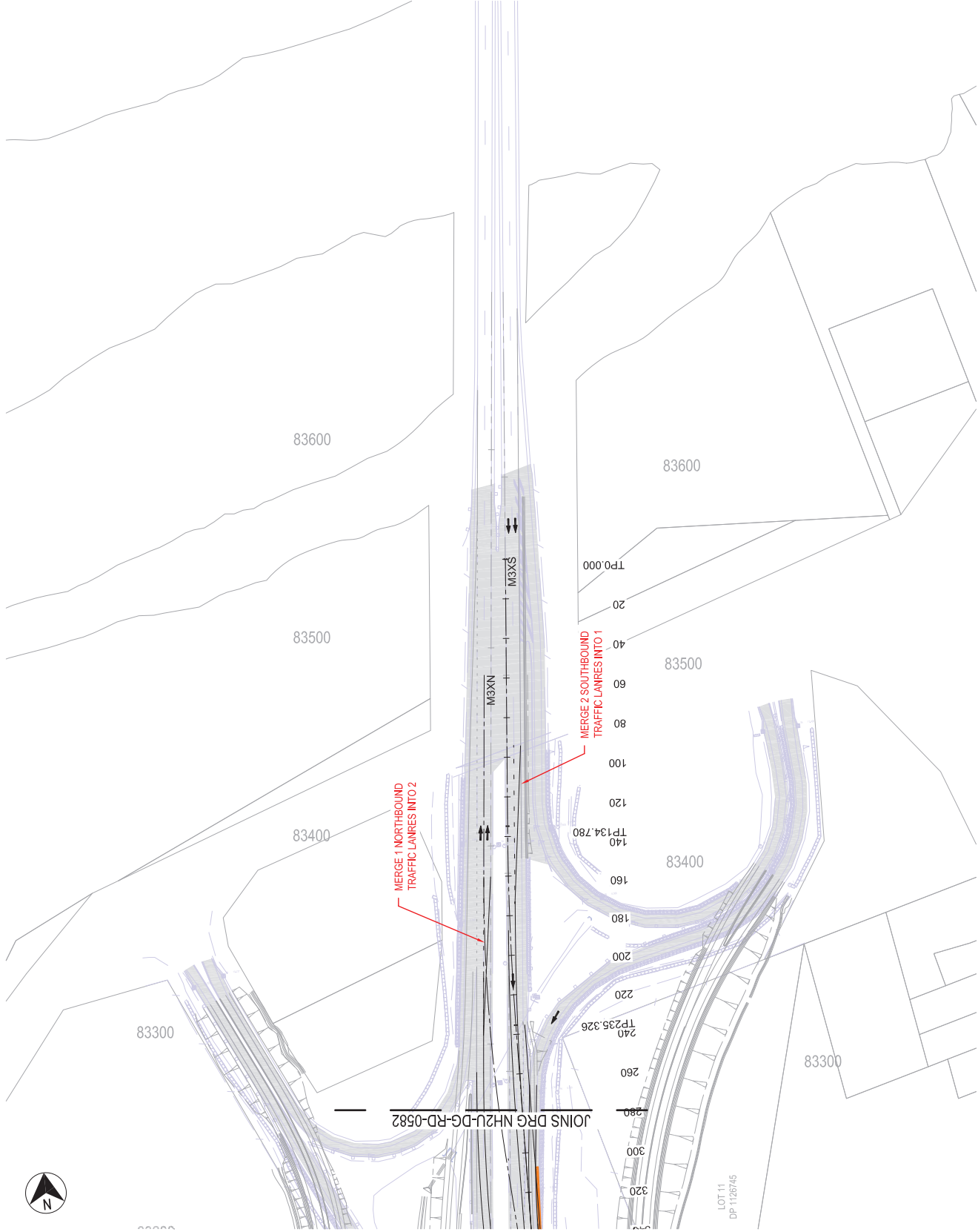

REV	DATE	BY	CHKD	APPD	DESCRIPTION	PROJECT			CONTRACTOR			CLIENT		
						NO	DATE	DATE	NAME	LOGO	NAME	LOGO	NAME	LOGO
A	05.09.2012	1	05.09.2012	05.09.2012	NSW	NSW	NSW	NSW	NSW	
B	05.10.2012	2	05.10.2012	05.10.2012	Transport Roads & Maritime Services	NSW	Transport Roads & Maritime Services	NSW	Transport Roads & Maritime Services	
C	31.01.2013	3	31.01.2013	31.01.2013	Abigroup	Abigroup	Abigroup	Abigroup	Abigroup	

STATUS	TMP SUBMISSION
VOLUME	DESIGN AND CONSTRUCTION CONTRACT
PHASE	DESIGN
REV	C

NAMBURCA AND BELINGEN SHIRE COUNCILS
 PACIFIC HIGHWAY UPGRADE
 NAMBURCA HEADS TO URUNGA
 HORIZONTAL & VERTICAL DESIGN
 TEMPORARY WORKS
 WATERFALL WAY INTERCHANGE SWITCH - SHEET 3

NO	1
DATE	05.09.2012
DATE	05.09.2012

NO	1
DATE	05.09.2012
DATE	05.09.2012

NO	1
DATE	05.09.2012
DATE	05.09.2012

NO	1
DATE	05.09.2012
DATE	05.09.2012

NO	1
DATE	05.09.2012
DATE	05.09.2012

NO	1
DATE	05.09.2012
DATE	05.09.2012

NO	1
DATE	05.09.2012
DATE	05.09.2012

NO	1
DATE	05.09.2012
DATE	05.09.2012

NO	1
DATE	05.09.2012
DATE	05.09.2012

This drawing may have been prepared using color plotting software. Color plotting is not guaranteed.

LEGEND

GENERAL

- EXISTING PAVEMENT
- SURVEY
- CADASTRAL (ACCURACY UNKNOWN)
- SITE BOUNDARY (SWTC APP.2)
- SITE BOUNDARY OFFSET (DISTANCE VARIES)
- LOCAL ROAD CORRIDOR BOUNDARY (AS MODIFIED FOR TENDER DESIGN)
- LOCAL ROAD CORRIDOR BOUNDARY (SWTC APP.3)
- AREA OF TEMPORARY PAVEMENTS

NOTES

1. FOR FURTHER DETAIL ON CLEARING EXTENTS REFER DRAWINGS NH2UJ-DG-EV-0001 TO 0048.
2. FOR FURTHER DETAIL ON PROPERTY WORKS REFER DRAWINGS NH2UJ-DG-PA-0001 TO 0125.

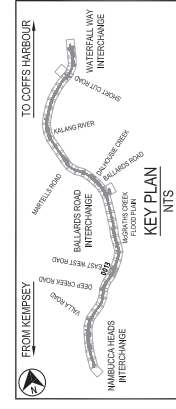
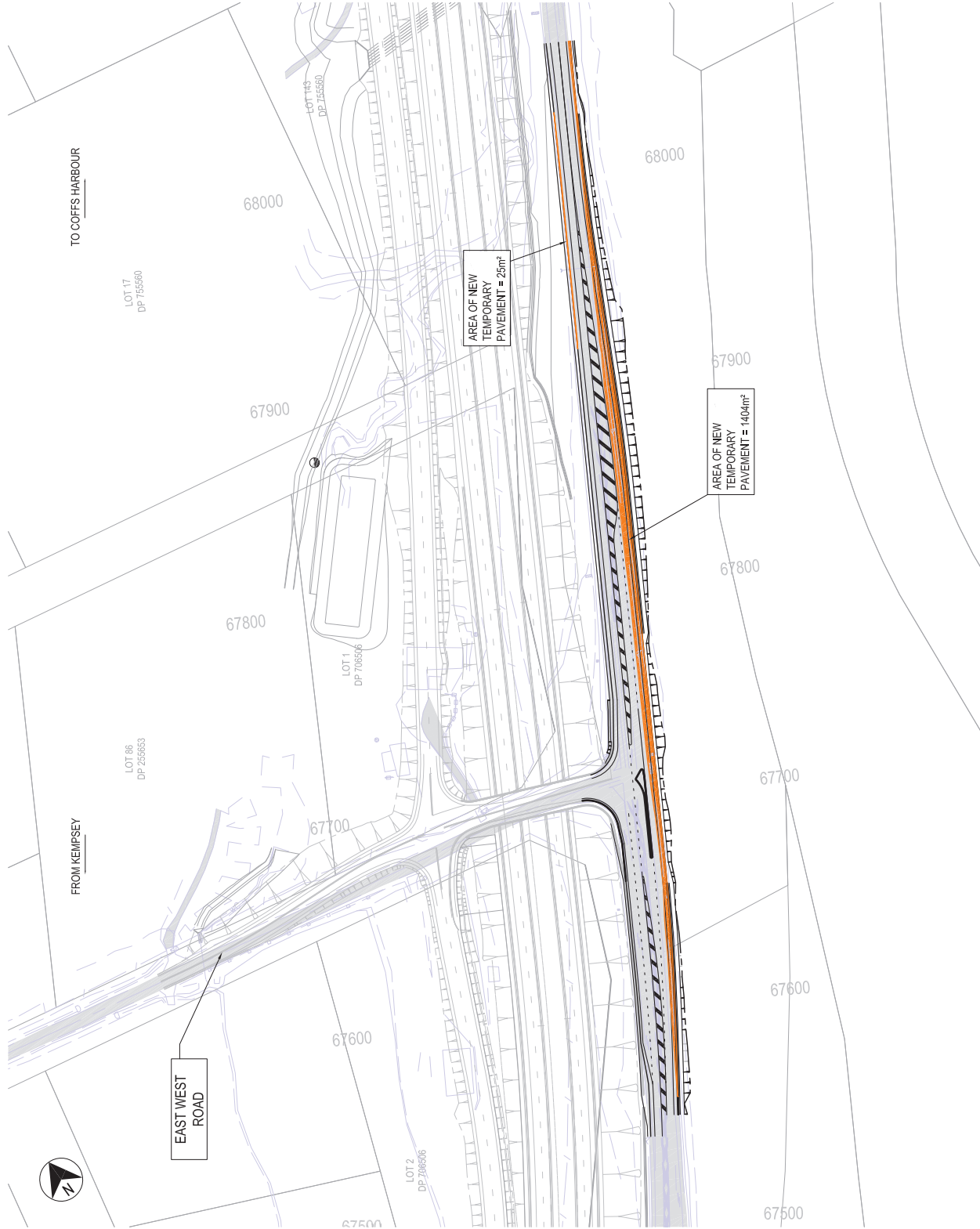

<p>STATUS</p> <p>TMP SUBMISSION</p> <p>DESIGN AND CONSTRUCTION CONTRACT</p>		<p>PROJECT</p> <p>NAMBUCCA AND BELLINGEN SHIRE COUNCILS PACIFIC HIGHWAY UPGRADE NAMBUCCA HEADS TO URUNGA HORIZONTAL & VERTICAL DESIGN TEMPORARY WORKS EAST WEST ROAD</p>		<p>CONTRACTOR</p> <p>Abigroup Constructing Australia's Future</p>		<p>CLIENT</p> <p>Transport Roads & Maritime Services NSW</p>		<p>SCALE</p> <p>SCALE 1:2000</p> <p>COORDINATE SYSTEM: GDA94</p> <p>MAP DATUM: GDA94</p>		<p>ORIGINAL DRAWING TITLE</p> <p>SCALE 1:2000</p> <p>COORDINATE SYSTEM: GDA94</p> <p>MAP DATUM: GDA94</p>		<p>DATE</p> <p>05/08/2012</p>		<p>DATE</p> <p>05/08/2012</p>		<p>DATE</p> <p>05/08/2012</p>		<p>DATE</p> <p>05/08/2012</p>	
<p>TITLE</p> <p>DESCRIPTION</p>		<p>DATE</p> <p>05/08/2012</p>		<p>DATE</p> <p>05/08/2012</p>		<p>DATE</p> <p>05/08/2012</p>		<p>DATE</p> <p>05/08/2012</p>		<p>DATE</p> <p>05/08/2012</p>		<p>DATE</p> <p>05/08/2012</p>		<p>DATE</p> <p>05/08/2012</p>		<p>DATE</p> <p>05/08/2012</p>			
<p>DATE</p> <p>05/08/2012</p>		<p>DATE</p> <p>05/08/2012</p>		<p>DATE</p> <p>05/08/2012</p>		<p>DATE</p> <p>05/08/2012</p>		<p>DATE</p> <p>05/08/2012</p>		<p>DATE</p> <p>05/08/2012</p>		<p>DATE</p> <p>05/08/2012</p>		<p>DATE</p> <p>05/08/2012</p>		<p>DATE</p> <p>05/08/2012</p>			
<p>DATE</p> <p>05/08/2012</p>		<p>DATE</p> <p>05/08/2012</p>		<p>DATE</p> <p>05/08/2012</p>		<p>DATE</p> <p>05/08/2012</p>		<p>DATE</p> <p>05/08/2012</p>		<p>DATE</p> <p>05/08/2012</p>		<p>DATE</p> <p>05/08/2012</p>		<p>DATE</p> <p>05/08/2012</p>		<p>DATE</p> <p>05/08/2012</p>			

This drawing may have been prepared using a color printer or a color copier.

Appendix B

Traffic Barrier Locations, Speed Zones and Site Access Points

A4 copies of these drawings are included here.



LEGEND

- SITE BOUNDARY (SWTC APP 2)
- ▤ PACIFIC HIGHWAY UPGRADE
- ▤ EXISTING HIGHWAY / LOCAL ROADS
- TYPE F BARRIER - PHASE 1
- TYPE F BARRIER - PHASE 2
- ➔ SITE ACCESS
- ▤ SITE ACCOMMODATION
- ▤ STOCK PILE AREAS

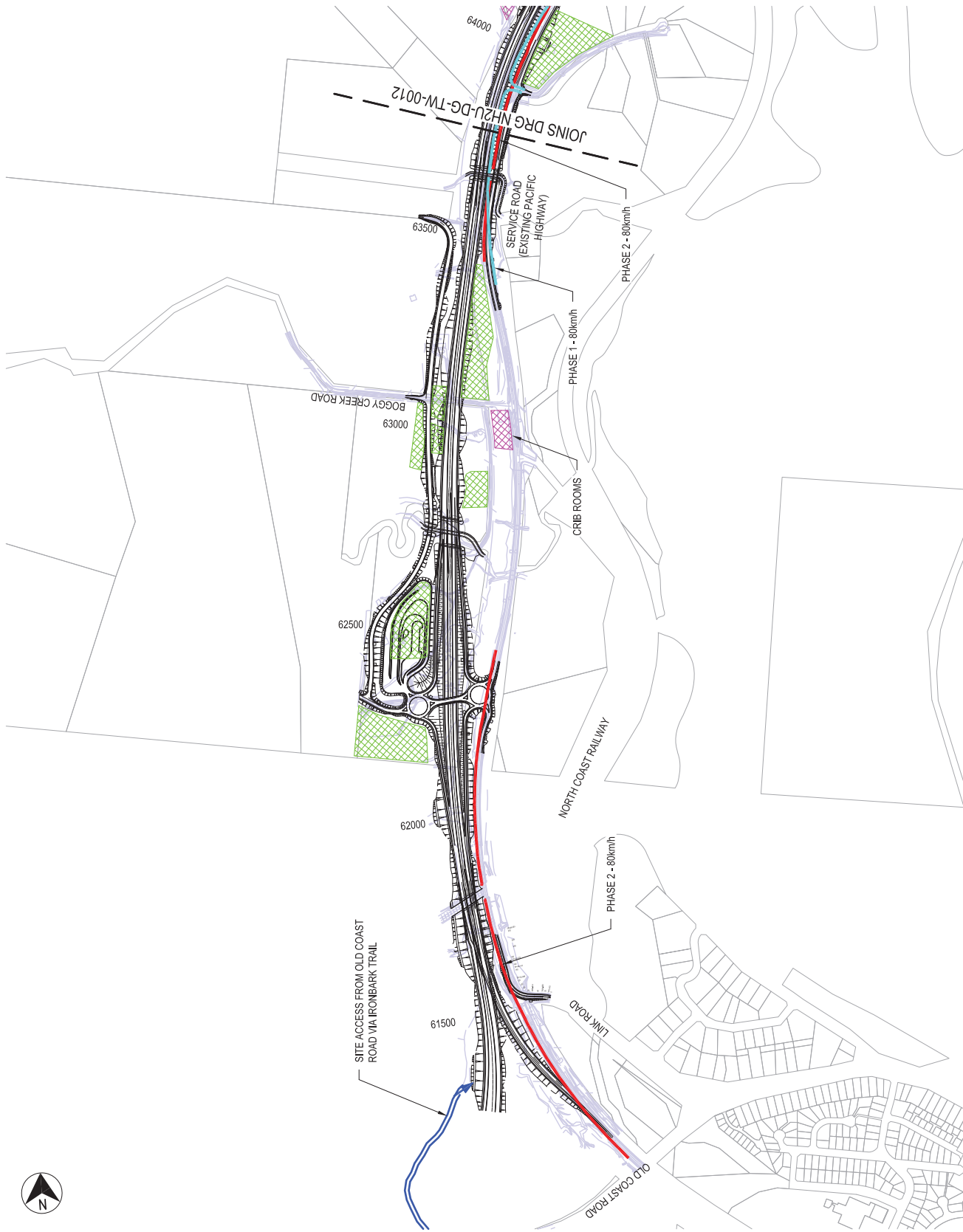

DATE: 31/01/2013 5:55:01 PM LOGN NAME: INF, BATCH (SM)
 LOCATION: \\N:\P\proj\311500\Deliverables\Drawings\Civil\dwg\07_Construction\Staging - Temporary Works\NH2U-DG-TW-0011-0019.dwg

STATUS TMP SUBMISSION <small>DESIGN AND CONSTRUCTION CONTRACT TN</small>		VOLUME TMP		REV B	
		PHASE TE		REV NH2U-DG-TW-0011	
PROJECT NAMBUCCA AND BELLINGEN SHIRE COUNCILS PACIFIC HIGHWAY UPGRADE NAMBUCCA HEADS TO URUNGA TEMPORARY BARRIER LOCATIONS, SITE ACCESS & SPEED ZONES DURING CONSTRUCTION SHEET 1		CONTRACTOR Constructing Australia's Future		CLIENT 	
SCALE SCALE 1:1000 0 100 200 <small>AS 13:2000</small>		ORIGINAL DRAWING TITLE CO-ORDINATE SYSTEM: MGA Zone 56 <small>MAPET 000000-2400</small>		DATE 05/08/2012	
TITLE	DATE	INITIALS	DATE	INITIALS	DATE
DESIGN	05/08/2012	S.H.	05/08/2012	S.H.	05/08/2012
CHECK	05/08/2012	G.C.	05/08/2012	G.C.	05/08/2012
DESIGNER		N.P.		N.P.	
CHECKER		B.J.		B.J.	
DESIGNER		F.N.		F.N.	
CHECKER		N.P.		N.P.	
DESIGNER		F.N.		F.N.	
CHECKER		N.P.		N.P.	
DESIGNER		F.N.		F.N.	
CHECKER		N.P.		N.P.	

This Drawing may have been prepared using a computer program for plotting.

LEGEND

- SITE BOUNDARY (SWTC APP 2)
- ▨ PACIFIC HIGHWAY UPGRADE
- ▨ EXISTING HIGHWAY / LOCAL ROADS
- TYPE F BARRIER - PHASE 1
- TYPE F BARRIER - PHASE 2
- SITE ACCESS
- ▨ SITE ACCOMMODATION
- ▨ STOCK PILE AREAS

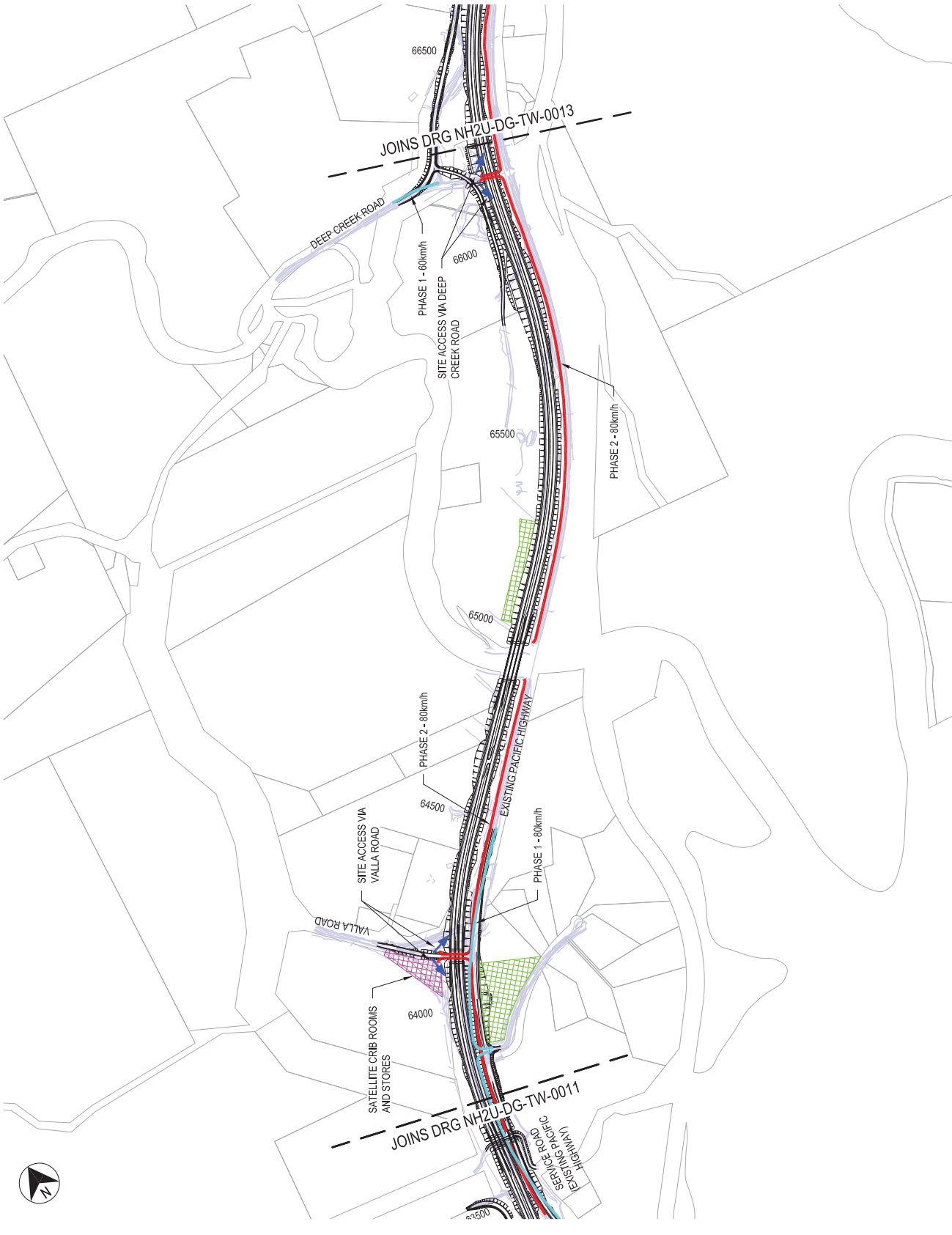

DATE: 31/10/2013 5:55:09 PM LOGIN NAME: INFR_BATCH (SM) LOCATION: I:\NTP\Proj\31012\NTP\Proj\31012\Bldg\Bldg\Drawings\31012\DWG\07\Construction\Sheeting - Temporary Works\NH2U-DG-TW-0011-0019.dwg	TITLE: TRAFFIC MANAGEMENT SUBMISSION DESIGNED BY: S.Z.T. DRAWN BY: B.J. CHECKED BY: N.P. APPROVED BY: F.N. DATE: 31.10.2012	TITLE: TRAFFIC MANAGEMENT SUBMISSION DESIGNED BY: S.Z.T. DRAWN BY: B.J. CHECKED BY: N.P. APPROVED BY: F.N. DATE: 31.10.2012	TITLE: TRAFFIC MANAGEMENT SUBMISSION DESIGNED BY: S.Z.T. DRAWN BY: B.J. CHECKED BY: N.P. APPROVED BY: F.N. DATE: 31.10.2012	ORIGINAL: 31/10/2012 11:45:10 SCALE: 1:10000 NORTHING: 6500000 EASTING: 6500000 UTM ZONE: 58 UTM DATUM: WGS 84	CLIENT: NSW TRANSPORT ROADS & MARITIME SERVICES CONTRACTOR: Abigroup CONSTRUCTING AUSTRALIA'S FUTURE	PROJECT: NAMBUCCA AND BELLINGEN SHIRE COUNCILS PACIFIC HIGHWAY UPGRADE NAMBUCCA HEADS TO URUNGA TEMPORARY BARRIER LOCATIONS, SITE ACCESS & SPEED ZONES DURING CONSTRUCTION SHEET 2	STATUS: TMP SUBMISSION VOLUME: 02 OF 02 CONTRACT CONTRACT NO: PHASE: TMP DRAWING NO: NH2U-DG-TW-0012 REV: B
--	--	--	--	---	---	---	--

This drawing may have been prepared using a color printer. If a black and white printer is used, the drawing may appear in shades of gray.

LEGEND

- SITE BOUNDARY (SWTC APP 2)
- ▬ PACIFIC HIGHWAY UPGRADE
- ▬ EXISTING HIGHWAY / LOCAL ROADS
- ▬ TYPE F BARRIER - PHASE 1
- ▬ TYPE F BARRIER - PHASE 2
- ➔ SITE ACCESS
- ▭ SITE ACCOMMODATION
- ▭ STOCK PILE AREAS

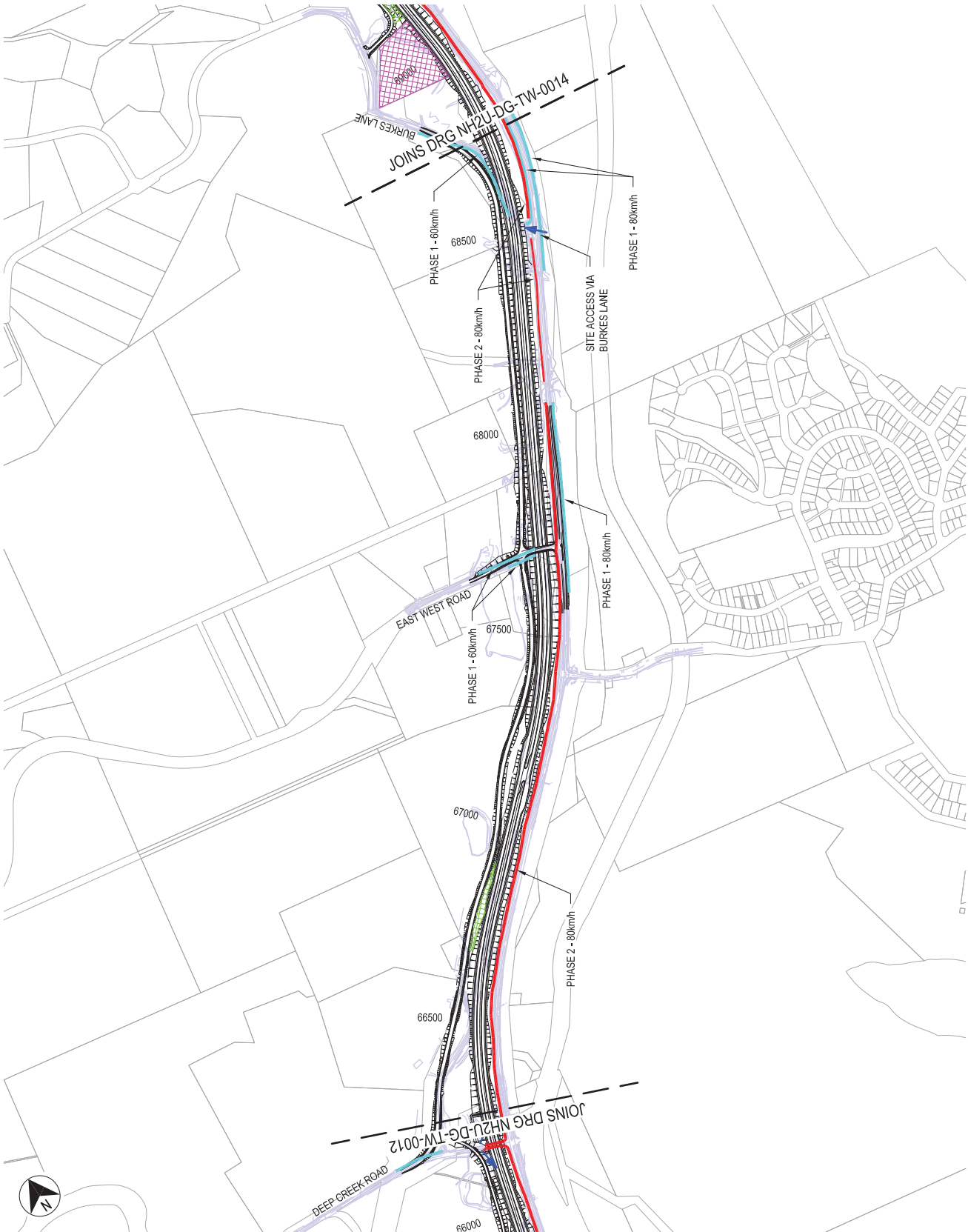

STATUS		TMP SUBMISSION <small>TEMPORARY CONSTRUCTION CONTRACT</small>
VOLUME	TMP	
PHASE	TE	
REV	REV	NH2U-DG-TW-0013
		B

PROJECT: NAMBUCCA AND BELLINGEN SHIRE COUNCILS
 PACIFIC HIGHWAY UPGRADE
 NAMBUCCA HEADS TO URUNGA
 TEMPORARY BARRIER LOCATIONS, SITE ACCESS
 & SPEED ZONES DURING CONSTRUCTION
 SHEET 3

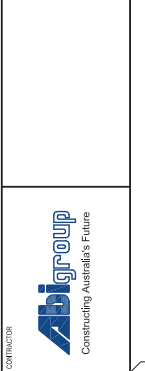

TITLE	DATE	DATE	DATE	DATE
DESIGN	05.08.2012	05.08.2012	05.08.2012	05.08.2012
CHECK	S.H.	G.C.	N.P.	F.H.
APPROVED	B.J.	N.P.	F.H.	N.L.

SCALE	SCALE	SCALE
1:1000	1:1000	1:1000
1:500	1:500	1:500
1:250	1:250	1:250

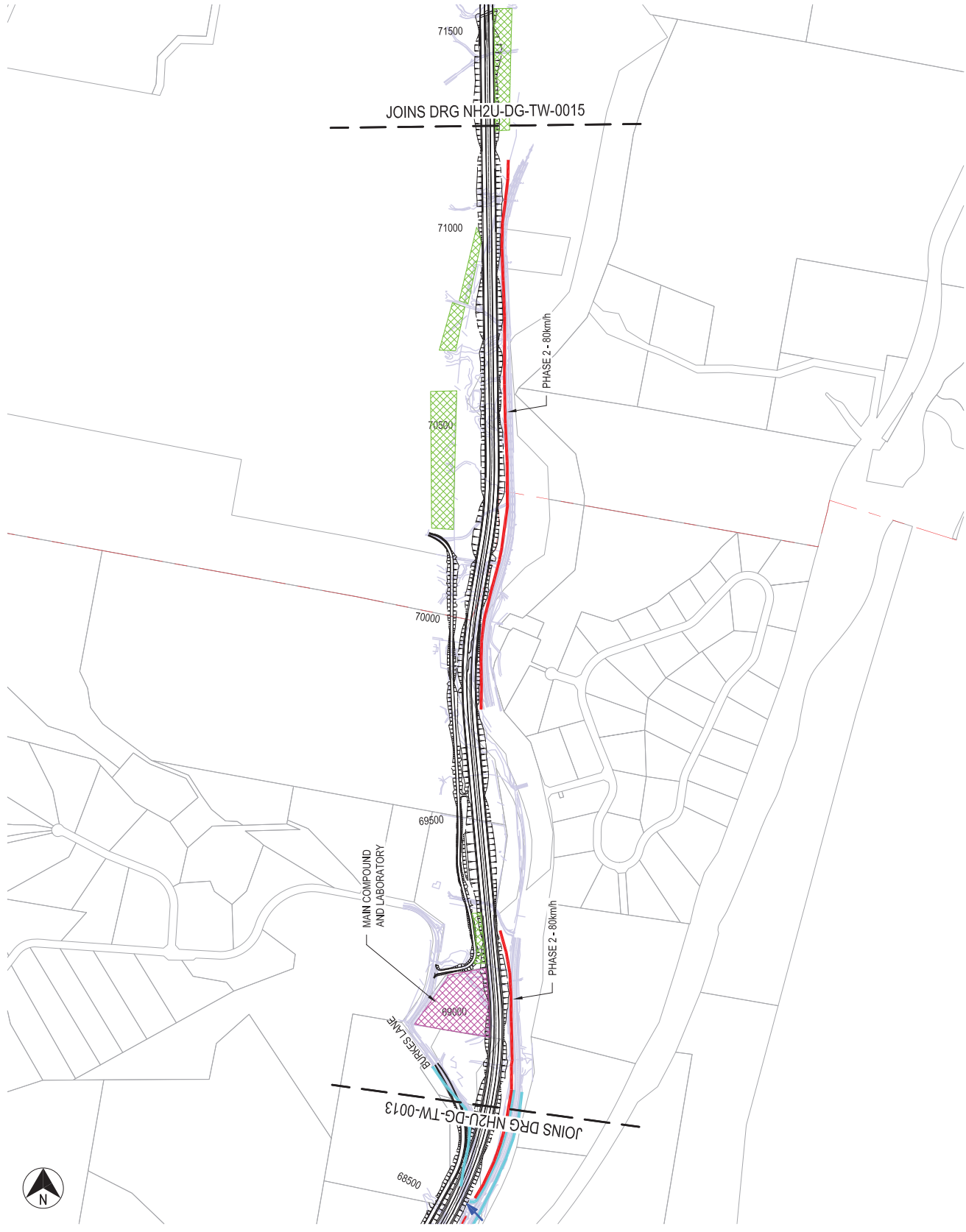

LEGEND

[Dashed line symbol]	SITE BOUNDARY (SWTC APP 2)
[Grey hatched symbol]	PACIFIC HIGHWAY UPGRADE
[Light blue hatched symbol]	EXISTING HIGHWAY / LOCAL ROADS
[Blue line symbol]	TYPE F BARRIER - PHASE 1
[Red line symbol]	TYPE F BARRIER - PHASE 2
[Blue arrow symbol]	SITE ACCESS
[Pink hatched symbol]	SITE ACCOMMODATION
[Green hatched symbol]	STOCK PILE AREAS

				PROJECT: NAMBUCCA AND BELLINGEN SHIRE COUNCILS PACIFIC HIGHWAY UPGRADE NAMBUCCA HEADS TO URUNGA TEMPORARY BARRIER LOCATIONS, SITE ACCESS & SPEED ZONES DURING CONSTRUCTION SHEET 4		STATUS: TMP SUBMISSION	
TITLE: PACIFIC HIGHWAY UPGRADE DRAWING NO: NH2U-DG-TW-0014		CONTRACTOR: Abigroup Constructing Australia's Future		VOLUME: TEMPERARY BARRIER LOCATIONS, SITE ACCESS & SPEED ZONES DURING CONSTRUCTION		REV: B	
SCALE: 1:100 SCALE 1:1000 SCALE 1:2500 SCALE 1:5000		ORIGINAL DRAWING TITLE:		DATE: 05/08/2012 DATE: 05/08/2012 DATE: 05/08/2012 DATE: 05/08/2012		DATE: 05/08/2012 DATE: 05/08/2012 DATE: 05/08/2012 DATE: 05/08/2012	
TITLE:		TITLE:		TITLE:		TITLE:	
DATE:		DATE:		DATE:		DATE:	
DRAWN BY:		DRAWN BY:		DRAWN BY:		DRAWN BY:	
CHECKED BY:		CHECKED BY:		CHECKED BY:		CHECKED BY:	
APPROVED BY:		APPROVED BY:		APPROVED BY:		APPROVED BY:	

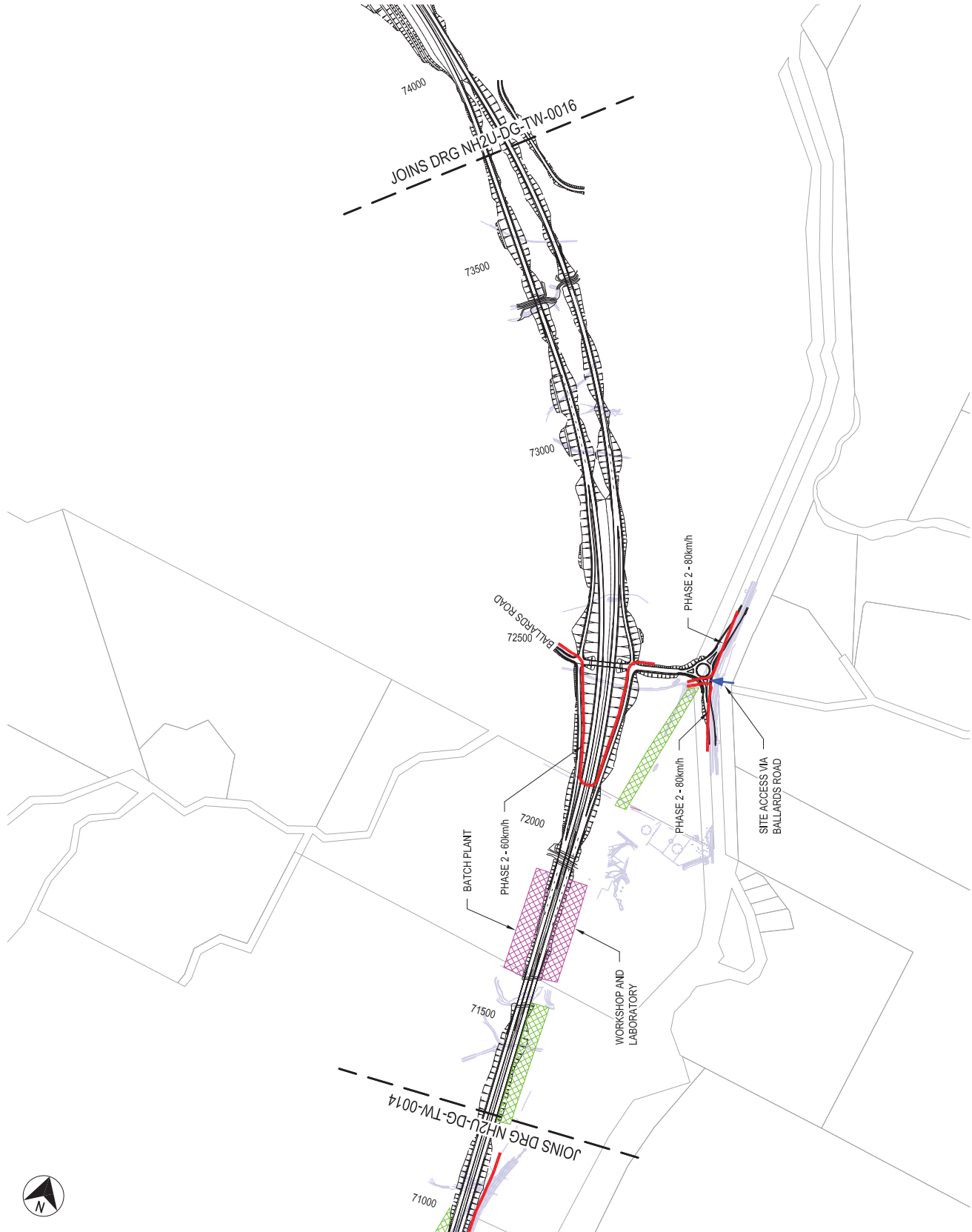

LEGEND

	SITE BOUNDARY (SWTC APP 2)
	PACIFIC HIGHWAY UPGRADE
	EXISTING HIGHWAY / LOCAL ROADS
	TYPE F BARRIER - PHASE 1
	TYPE F BARRIER - PHASE 2
	SITE ACCESS
	SITE ACCOMMODATION
	STOCK PILE AREAS

 TRANSPORT ROADS & MARITIME SERVICES		 Abigroup Constructing Australia's Future		PROJECT NAMBUCCA AND BELLINGEN SHIRE COUNCILS PACIFIC HIGHWAY UPGRADE NAMBUCCA HEADS TO URUNGA TEMPORARY BARRIER LOCATIONS, SITE ACCESS & SPEED ZONES DURING CONSTRUCTION SHEET 5		STATUS TMP SUBMISSION	
TITLE TRAFFIC MANAGEMENT SUBMISSION TENDER SUBMISSION		DATE 31.01.2013 05.08.2012		ORIGINAL DRAWING / SCALE SCALE 1:1000 100 0 100 200 METRES 1:1000 100 0 100 200 METRES		VOLUME TMP	
DRAWN A. S. Z. T.		CHECKED B. J.		APPROVED N. P.		PHASE TE	
DESIGNED S. Z. T.		VERIFIED B. J.		PROJECT MANAGER N. P.		DRAWN BY NH2U-DG-TW-0015	
REVISIONS 1. DATE: 31.01.2013 2. DATE: 05.08.2012		REVISIONS 1. DATE: 31.01.2013 2. DATE: 05.08.2012		REVISIONS 1. DATE: 31.01.2013 2. DATE: 05.08.2012		REV B	

This drawing may have been prepared using a color printer and may be a scanned copy of a printed drawing.