



Australian Government

**BUILDING OUR FUTURE**



Aerial view looking south from Dirty Creek towards Corindi Beach

# Woolgoolga to Ballina project

Woolgoolga to Glenugie traffic staging – Pacific Highway upgrade – July 2017

The Australian and NSW governments are jointly funding the \$4.36 billion Woolgoolga to Ballina Pacific Highway upgrade. Roads and Maritime Services Pacific Highway Project Office and Pacific Complete are working together to deliver the project.

## In this update

- Overview
- Whats happening
- Traffic staging
- Local access arrangements
- Operational noise management
- Next steps

## Overview

The Woolgoolga to Ballina Pacific Highway upgrade project will duplicate about 155 kilometres from about six kilometres north of Woolgoolga (north of Coffs Harbour) to about six kilometres south of Ballina. The 26 kilometre Woolgoolga to Glenugie upgrade is part of this project and is being built in two sections.

The first section is the Woolgoolga to Halfway Creek project. This project involves upgrading 14 kilometres of highway to four lane divided road between Arrawarra Interchange and south of Grays Road at Halfway Creek. The project includes building a new rest area at Arrawarra, an interchange at Range Road, twin bridges over the floodplain at Corindi and local access bridges over the highway upgrade at Sherwood Creek Road and Kangaroo Trail Road.

The second section is the Halfway Creek to Glenugie project. This project involves upgrading 12 kilometres of highway to a four lane divided road between Grays Road and Franklins Road at Glenugie. The project includes building new twin bridges over Halfway Creek and Wells Crossing Creek and a new heavy vehicle inspection bay. Both projects are about 80 per cent complete and expected to open to traffic in 2017, weather permitting.

## What's happening

The Woolgoolga to Glenugie upgrade will progressively open to traffic in four stages. A diagram of how the highway traffic staging will work is provided on page two and three.

### Grays Road to Franklins Road

In the coming months all highway traffic will be divided with southbound motorists traveling on the new southbound carriageway for about 12 kilometres with a temporary speed limit of 100 kilometres/hour. As part of this first stage northbound motorists will temporarily travel on about six kilometres on new northbound carriageway with a temporary speed limit of 100 kilometres/hour, between just north of Rediger Close and just south of the bridge at Wells Crossing. Traveling north from Wells Crossing Creek motorists will temporarily use the existing northbound carriageway and existing bridge over Wells Crossing Creek. This temporary arrangement has a reduced speed limit of 80 kilometres/hour, to approach and cross the bridge, with the speed limit increasing to 100 kilometres/hour near Parkers Road. This arrangement will be in place until the northbound carriageway is improved as part of the Glenugie to Ballina Pacific Highway upgrade in 2018 and 2019.

### Arrawarra Interchange to Range Road

The second stage involves moving all highway traffic onto about 10 kilometres of new four lane divided road with a speed limit of 110 kilometres/hour. We expect this to occur in late 2017, weather permitting. This traffic staging arrangement will connect the Woolgoolga to Halfway Creek upgrade with the existing 25 kilometre Sapphire to Woolgoolga upgrade at the Arrawarra Interchanges and connects about 35 kilometres of upgraded four lane divided road north of Coffs Harbour, with a speed limit of 110 kilometres/hour, north of Coffs Harbour. As part of this stage the existing Pacific Highway between Corindi Beach and Dirty Creek will become a local service road and change name to Solitary Islands Way. This involves connecting Eggins Drive with the existing Pacific Highway south of Tasman Street. This new section of Solitary Islands Way connects the local service road between Sapphire Beach and Dirty Creek.

### Range Road to Grays Road

All highway traffic was moved onto about four kilometres of new northbound carriageway in a temporary contraflow arrangement in April. This temporary arrangement allows the new southbound carriageway to be built and has a speed limit of 80 kilometres/hour and allows the new southbound carriageway to be built and the third stage of four lane divided road to be completed. Once this work is complete all highway traffic will be divided onto the new carriageways and the speed limit will be increased to 110 kilometres/hour. We expect this will occur in early 2018, weather permitting.

### Wells Crossing to Franklins Road

The final stage involves improving the northbound carriageway between Wells Crossing and Franklins Road as part of the Glenugie to Ballina Pacific Highway upgrade in 2018 and 2019.

## Traffic staging

### 1 Current stage

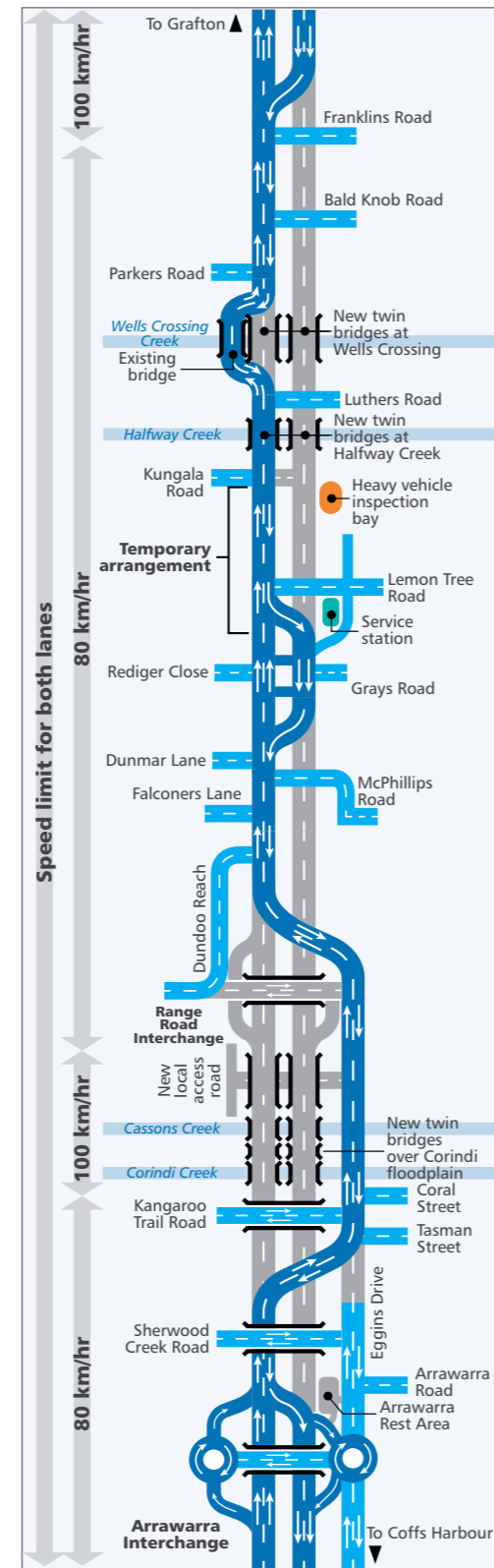

### 2 Temporary stage - mid to late 2017

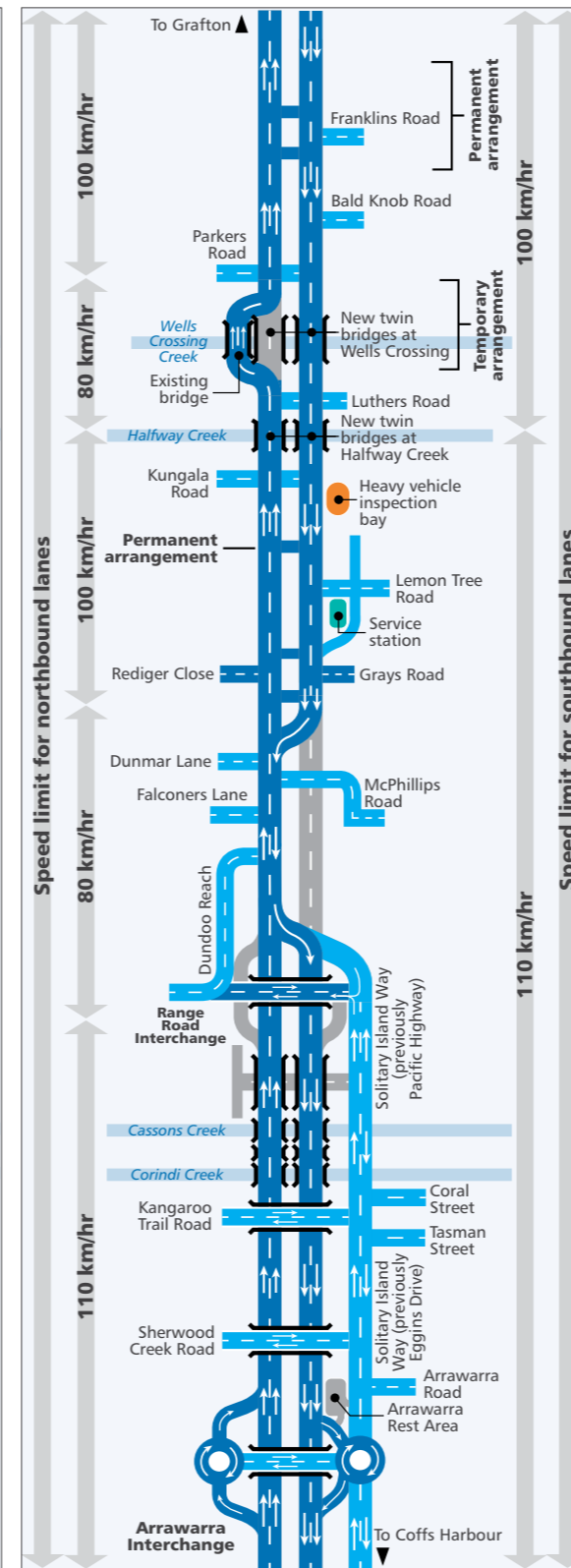

### 3 Final stage 1 - early 2018

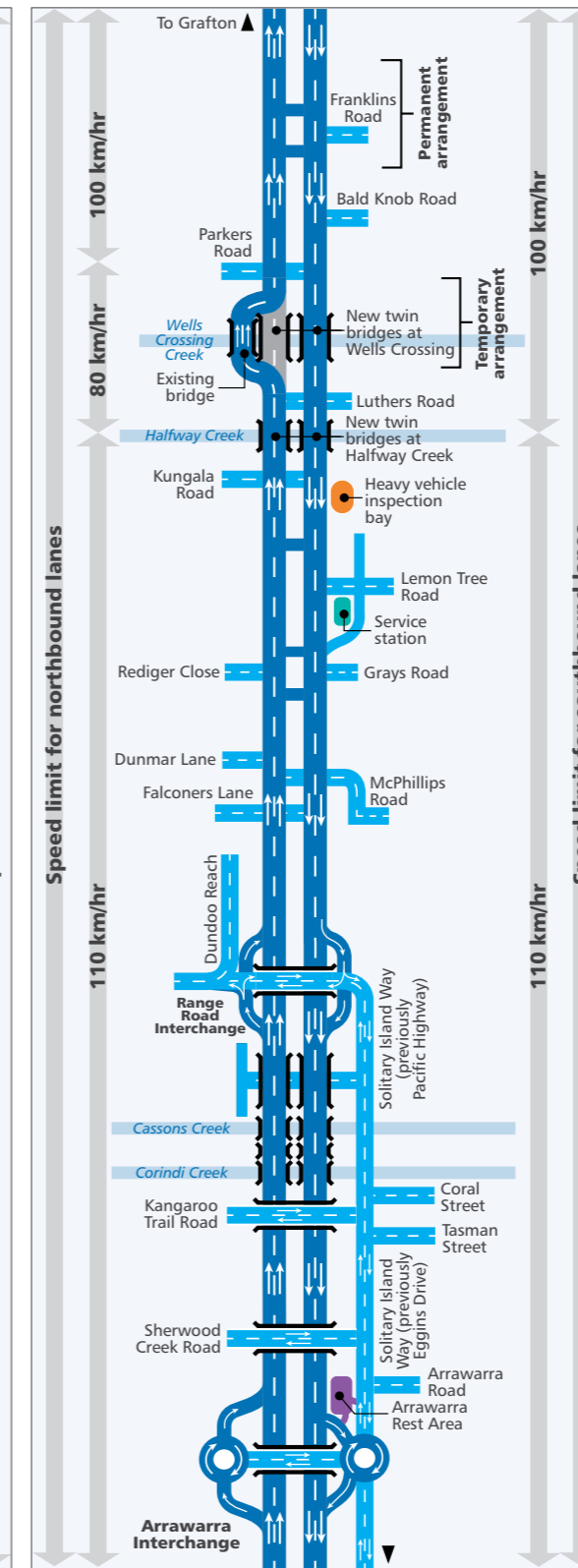

### 4 Final stage 2 - late 2019

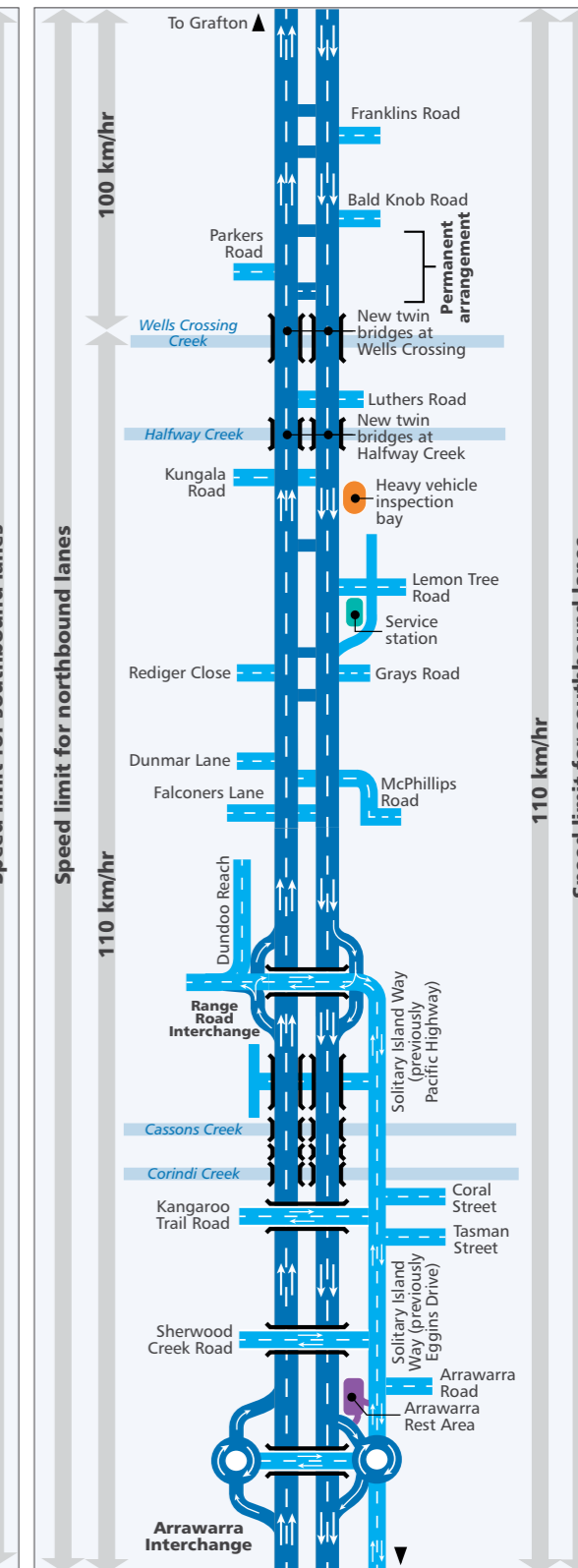

#### LEGEND

- █ Open to traffic
- █ Local roads
- █ Under construction
- ▬ Bridges
- █ Rest areas
- █ Vehicle inspection bay
- █ Service station



## Local access arrangements

### Woolgoolga to Halfway Creek section

#### Arrawarra to Range Road (see Figure 1)

The new highway upgrade, between north of Arrawarra Interchange and south of the new Range Road Interchange at Dirty Creek, involves opening about 10 kilometres of new four lane divided road with a speed limit of 110 kilometres/hour. This part of the highway upgrade provides new

overbridges for local access to Sherwood Creek Road and Kangaroo Trail Road, new bridges over the floodplain near Corindi and a new rest area near the Arrawarra Interchange.

All highway traffic will be moved onto the new upgrade section of the highway north of Arrawarra Interchange in mid to late 2017, weather permitting. At this stage, Eggins Drive and the existing Pacific Highway will become a local service road and change name to Solitary Island Way.

**Figure 1** Arrawarra to Range Road

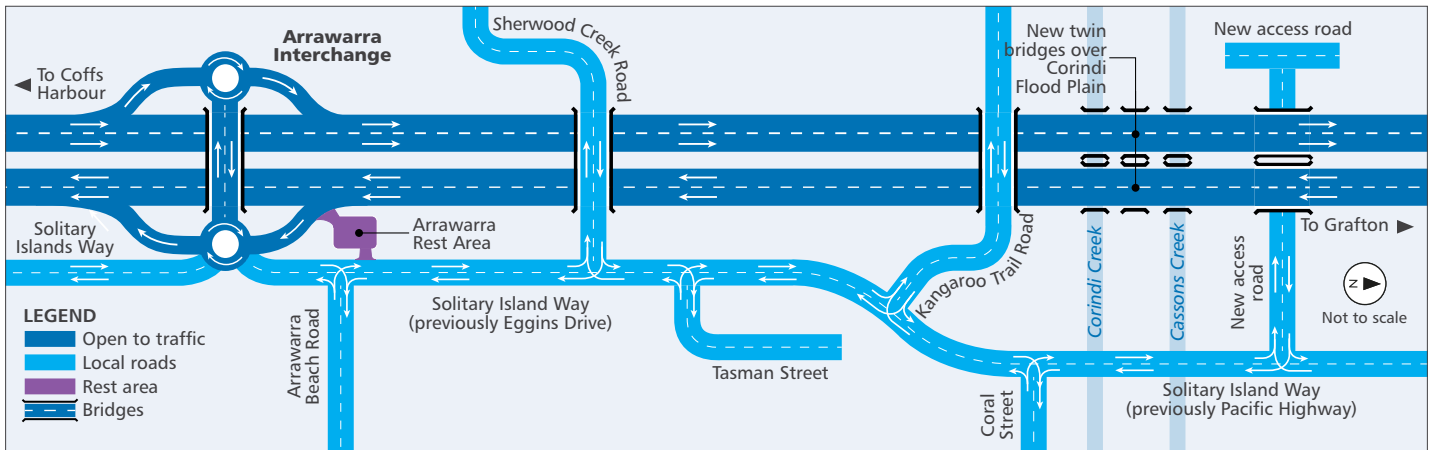

#### Range Road to Halfway Creek (see Figure 2)

All highway traffic was temporarily moved onto about four kilometres of new northbound carriageway north of Range Road in a contraflow arrangement in April 2017. This contraflow arrangement has a temporary speed limit of 80 kilometres/hour and allows the new southbound carriageway to be built.

The highway upgrade in this area provides a new interchange at Range Road. The interchange will progressively open to traffic as finishing work on the on and off ramps is completed. It will become fully operational once the new southbound carriageway is built. We expect the southbound carriageway will open to traffic in early 2018, weather permitting.



New northbound lanes near Dirty Creek

**Figure 2** Range Road to Halfway Creek

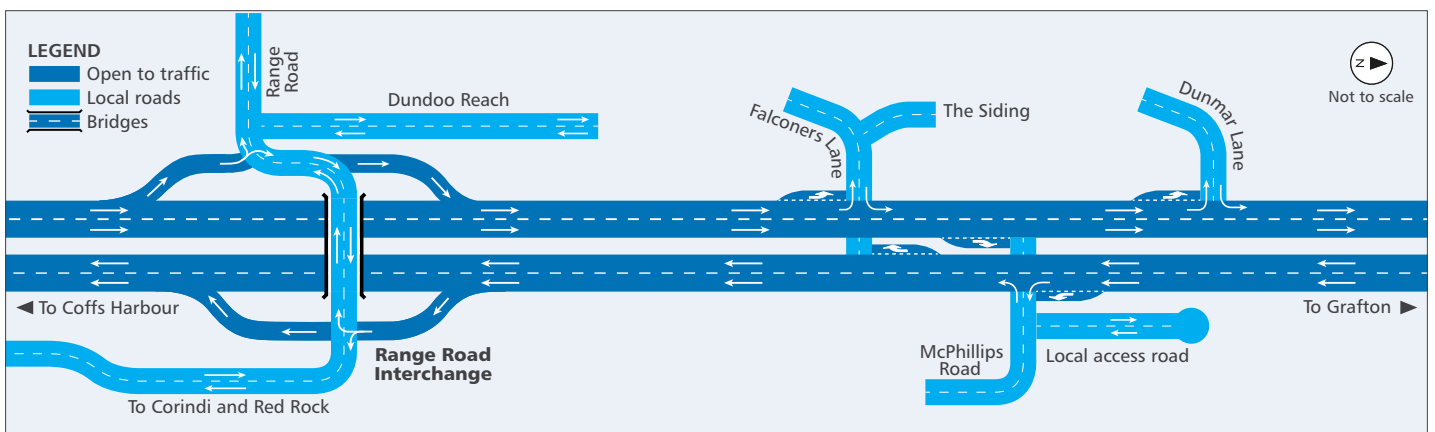

### Halfway Creek to Glenugie section

#### Halfway Creek to Wells Crossing (see Figure 3)

All highway traffic was temporarily moved onto about six kilometres of new northbound carriageway, between the existing dual carriageway south of Grays Road and Wells Crossing Creek, in September 2016. This contraflow arrangement has a temporary speed limit of 80 kilometres/hour and allows the new southbound carriageway to

be built. Once the southbound carriageway is complete highway traffic will be divided onto the new carriageways and the speed limit will be temporarily increased to 100 kilometres/hour. We expect this to occur in mid to late 2017.

The highway upgrade in this area provides new twin bridges over Halfway Creek, improved intersections for Lemon Tree Road, Kungala Road and Luthers Road and a new heavy vehicle inspection bay.

**Figure 3** Halfway Creek to Wells Crossing

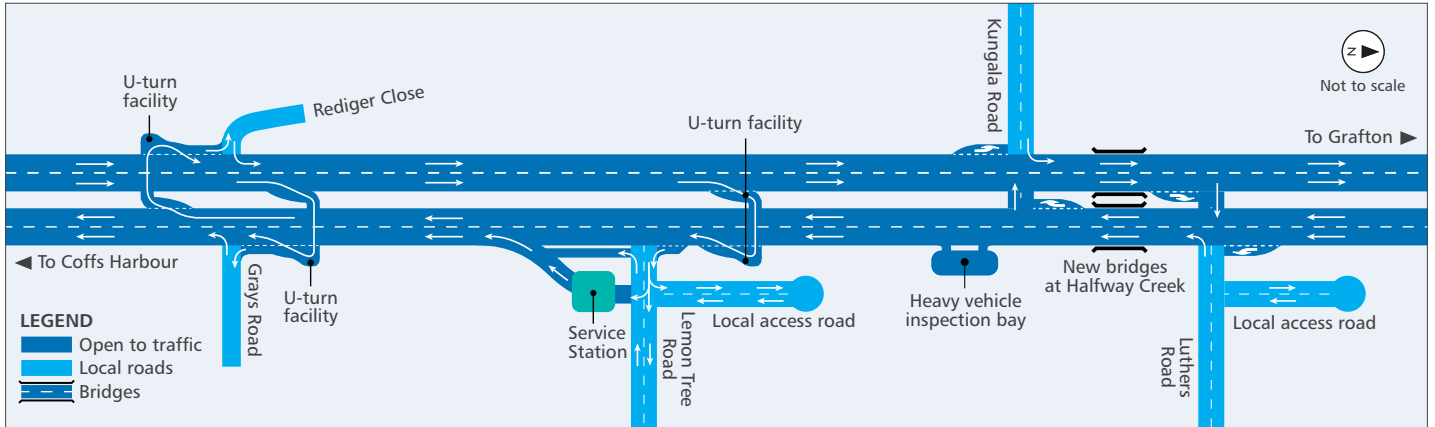

#### Wells Crossing to Glenugie (see Figure 4)

Traffic staging will be delivered in two stages in this part of the upgrade. The first stage is a combination of temporary and permanent traffic arrangements delivered in 2017. The second stage delivers the permanent traffic arrangements when we improve the northbound carriageway in 2018 and 2019. The first stage provides about six kilometres of new southbound carriageway with a temporary speed limit of 100 kilometres/hour and uses the new southbound bridge over Wells Crossing Creek. The existing northbound carriageway will be used in this stage with a temporary speed limit of 100 kilometres/hour. This arrangement involves using the existing bridge over Wells Crossing Creek, with reduced temporary speed limit of 80 kilometres/hour for a short distance to safely approach and cross the bridge. The speed limit will increase to 100 kilometres/hour near Parkers Road. The second stage involves improving the northbound carriageway as part of the Glenugie to Ballina Pacific Highway upgrade in 2018 and 2019.



Paving on northbound carriageway south of Wells Crossing

**Figure 4** Wells Crossing to Glenugie

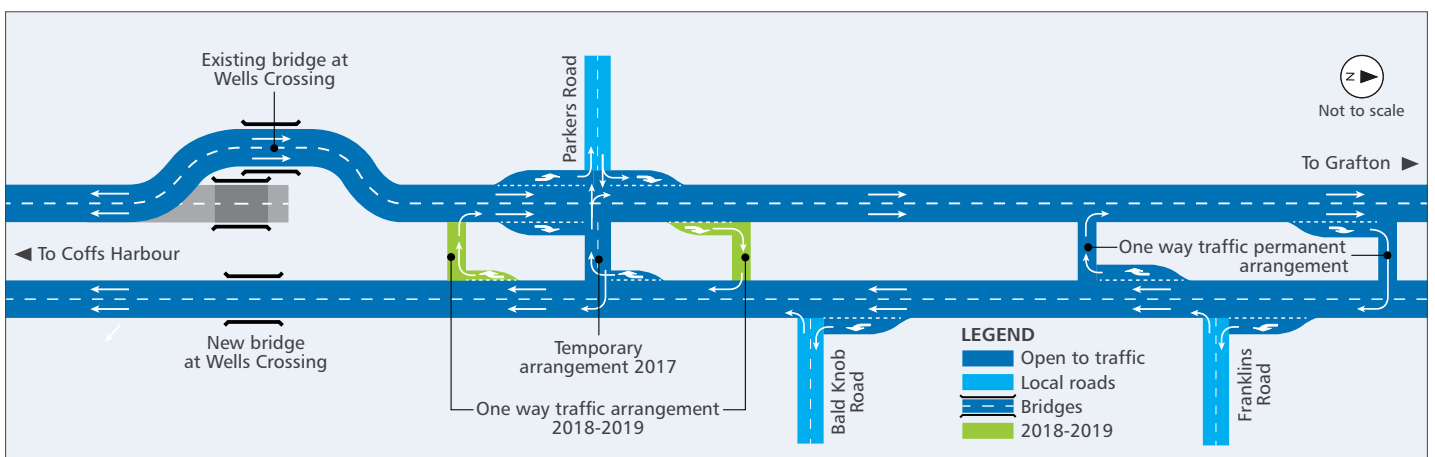

## Operational noise management

In 2015, an operational noise management report for the Woolgoolga to Glenugie project was produced in accordance with the NSW Environment Protection Authority's Roads Noise Policy and Roads and Maritime Services Noise Guidelines. The report outlines the predicted noise levels of the upgrade on nearby residences and takes into account the impact of traffic noise from the existing highway and traffic noise from the upgrade, as well as the impact of increased traffic volumes to the year 2026. The report is used to develop road traffic noise mitigation treatments for the project. To find out more about the operational noise management report, go to this webpage: <http://www.rms.nsw.gov.au/documents/projects/factsheet-traffic-noise.pdf>

## Post construction noise monitoring

Under the project's Conditions of Approval, Roads and Maritime has a requirement to verify the predictions of the noise model made in the operational noise management report. This involves taking noise measurements at various locations along the project and comparing the results to the noise model predictions. If this process identifies any properties with noise levels higher than the prediction, additional noise mitigation treatments may be considered. A post-construction operational noise report will be prepared and will be made available to the community.

## Next steps

Work on the post construction noise assessment is normally scheduled for completion within 12 months of the road opening to allow for all work to be completed and for the traffic patterns to settle. You will be advised when the operational noise report is complete, and a copy will be made available.

I hope you find this information useful. If you need any additional information regarding traffic noise from the Woolgoolga to Ballina upgrade project please call the community information line 1800 778 900 (toll free)

**The project team would like to thank the community for your patience and support during the building of this project**



Aerial view of the new bridges over the floodplain near Corindi Beach

## Privacy

Roads and Maritime Services ("RMS") is subject to the *Privacy and Personal Information Protection Act 1998* ("PIIP Act") which requires that we comply with the Information Privacy Principles set out in the PIIP Act.

All information in correspondence is collected for the sole purpose of assisting in the assessment of this proposal/ delivering this project. The information received, including names and addresses of respondents, may be published in subsequent documents unless a clear indication is given in the correspondence that all or part of that information is not to be published. Otherwise RMS will only disclose your personal information, without your consent, if authorised by the law. Your personal information will be held by RMS at 76 Victoria St, Grafton NSW. You have the right to access and correct the information if you believe that it is incorrect.

