



## Temporary traffic change at Whites Road, New Italy

Roads and Maritime Services, Pacific Complete and its contractor partners are working together to deliver the Woolgoolga to Ballina Pacific Highway upgrade.

As part of building the upgrade between Devils Pulpit and Woodburn, there will be a temporary traffic change at Whites Road, New Italy.

The existing intersection at Whites Road and the Pacific Highway will change functionality from December, weather permitting. Traffic will not be able to turn left onto the highway from this intersection. A new left out only temporary access point will be available about 80 metres north.

At this time, the u-turn facility at Whites Road will only be available for southbound Pacific Highway traffic. This facility will not be able to accommodate heavy vehicles more than 19 metres long; these vehicles will need to use the u-turn facility about nine kilometres south at Serendipity Road, Tabbimoble. The u-turn facility about two kilometres north opposite Nortons Road, New Italy, is available for northbound Pacific Highway traffic.

As part of this change, the bus stop at Whites Road will be moved to a new temporary location where the access road and Whites Road connects. Temporary traffic lights will be installed on the access road to allow construction vehicles to cross and access the work area.

Motorists will be kept informed about dates and the traffic change through electronic message signs and [livetraffic.com.au](http://livetraffic.com.au).

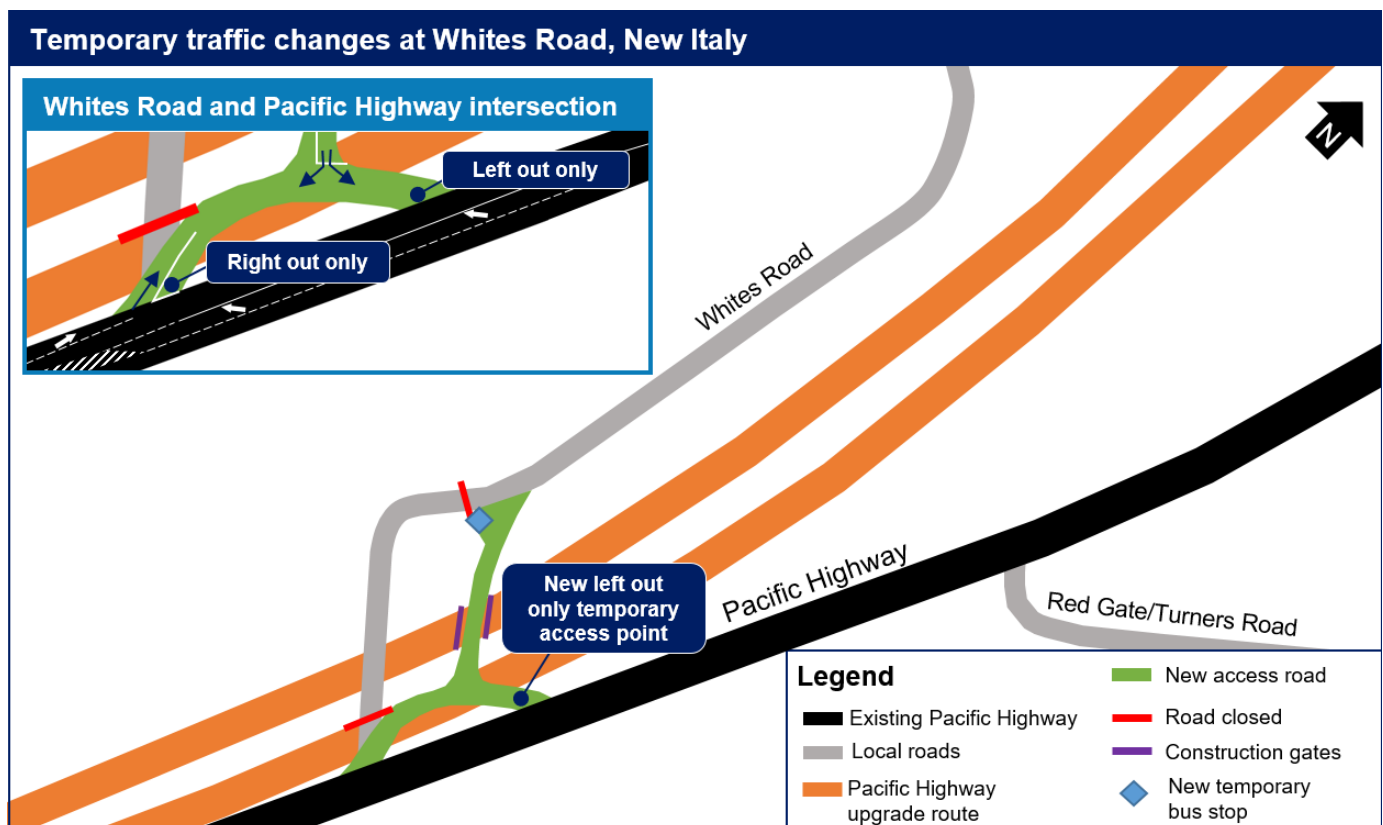

## How we manage our work

The project team will use machinery that generates noise, light and vibration. To manage this work, we will:

- turn off machinery when not in use
- direct temporary lighting down and away from homes
- locate equipment such as generators as far as possible from residences
- plan activities to minimise noise from reversing vehicles
- monitor noise so we can manage any potential impacts and adjust our work, as required.

All work will be carried out in line with the project's Conditions of Approval and Construction Environmental Management Plan.

## Work hours

Typically work will be carried out during the project's approved construction hours, which are:

Approved construction hours	
Monday to Friday 7am–6pm	
Saturday 8am–5pm	

In areas where residents live more than 200 metres from the work, extended approved work hours are allowed between 6am and 7am and 6pm and 7pm from Monday to Friday. No work will be carried on Sunday or a public holiday.







## Work outside of approved construction hours

To complete the temporary traffic changes, work is required outside approved construction hours. This work will include asphaltting and barrier movements and is planned between 6pm and 7am for up to two nights in December, weather permitting.

## Traffic changes

To manage queuing and safety, there will be some temporary traffic changes and lane closures that may affect travel times. Please keep to speed limits and follow the direction of traffic controllers and signs. Motorists are encouraged to remember PAC – Plan, Awareness, Caution. For the latest traffic updates, you can call 132 701, visit [livetraffic.com](http://livetraffic.com) or download the Live Traffic NSW app.

We apologise for any inconvenience and thank you for your patience during this important work.

Subscribe now	For more information
We can keep you up to date about what's happening in your area or if you are interested in a specific topic. Register your interest:	 1800 778 900 (toll free)
 1800 778 900 (toll free)	 <a href="mailto:W2B@pacificcomplete.com.au">W2B@pacificcomplete.com.au</a>
 <a href="mailto:W2B@pacificcomplete.com.au">W2B@pacificcomplete.com.au</a>	 <a href="http://pacifichighway.nsw.gov.au">pacifichighway.nsw.gov.au</a>
If you need help understanding this information, please contact the Translating and Interpreting Service on 131 450 and ask them to call us on 1800 778 900.	 Follow NSW Roads

  
131 450