

Korora Bus Interchange and Luke Bowen pedestrian bridge



Artist impression of Luke Bowen pedestrian bridge and Korora Bus Interchange, looking south

Key features:

- The Korora Bus Interchange provides a kiss and ride, parking, bus shelters and bus pullover bays
- The bus shelters are designed to complement the steel truss aesthetic of the new Luke Bowen pedestrian bridge and are made from transparent materials for crime prevention and improved safety outcomes
- Landscaping provides amenity, shade for patrons and visual continuity with the adjacent highway
- Aboriginal art features on the noise wall between Solitary Islands Way and the Pacific Highway, as well as on the bus shelters
- The Luke Bowen pedestrian bridge provides a safe connection from the eastern and western sides of the Pacific Highway
- The steel truss bridge has been designed to look like a sculpture, offering an open view for users
- The bridge serves as an interesting visual feature for motorists entering and exiting Coffs Harbour in the north.



Artist impression of the Luke Bowen pedestrian bridge looking north



Artist impression of the Luke Bowen pedestrian bridge – view from bridge

Coffs Harbour Bypass

Artwall locations and cultural themes

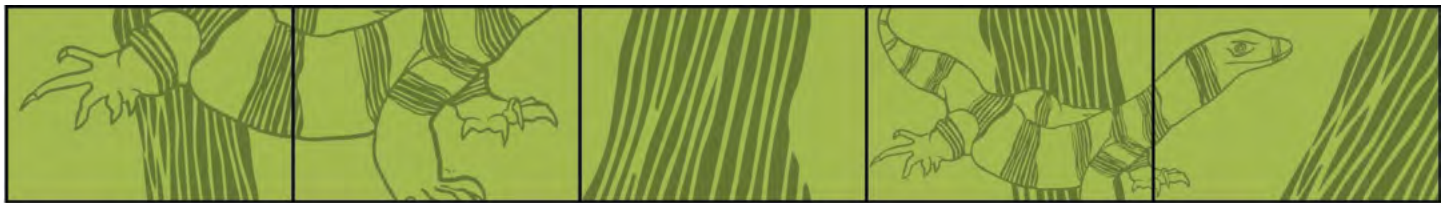
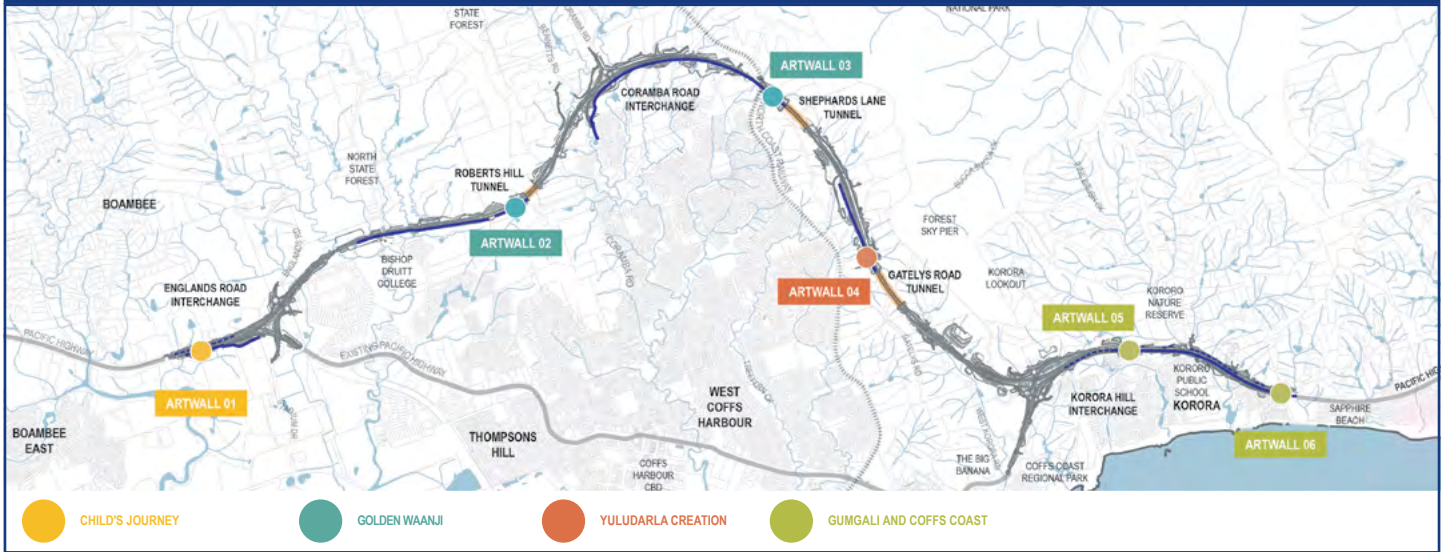

Artwork design for artwall 4 - 5x panels



Artwork design for artwall 4 - repeat example

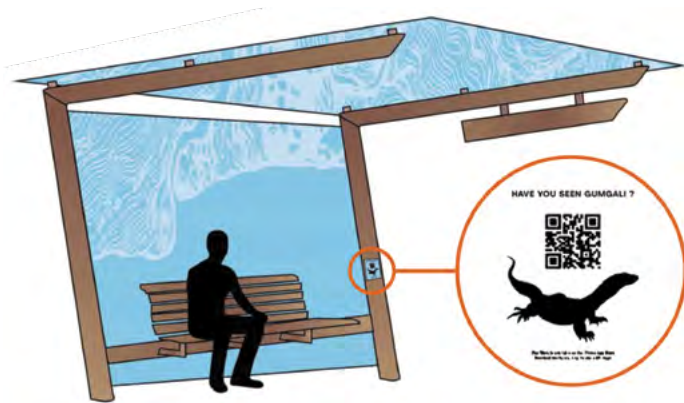

Artist impression of Aboriginal art incorporated onto bus shelter with interactive QR code for education

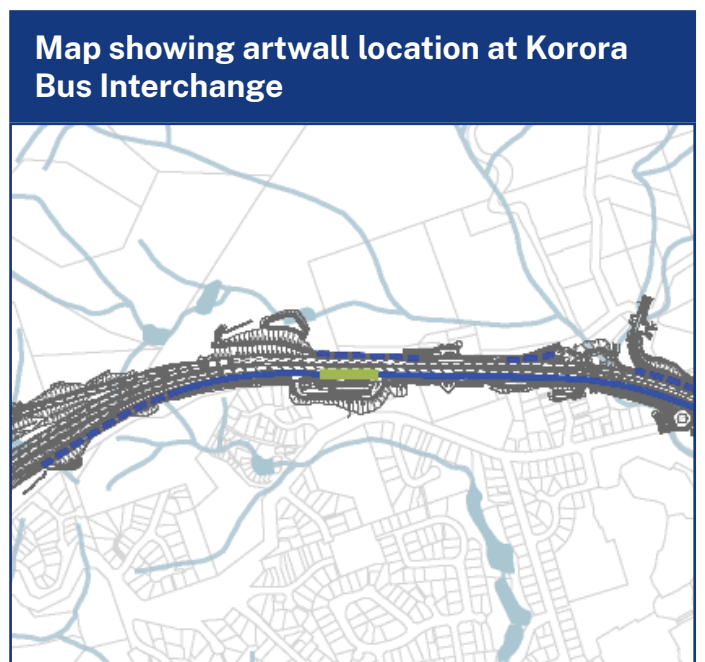

Urban design concept plan – Korora Bus Interchange south

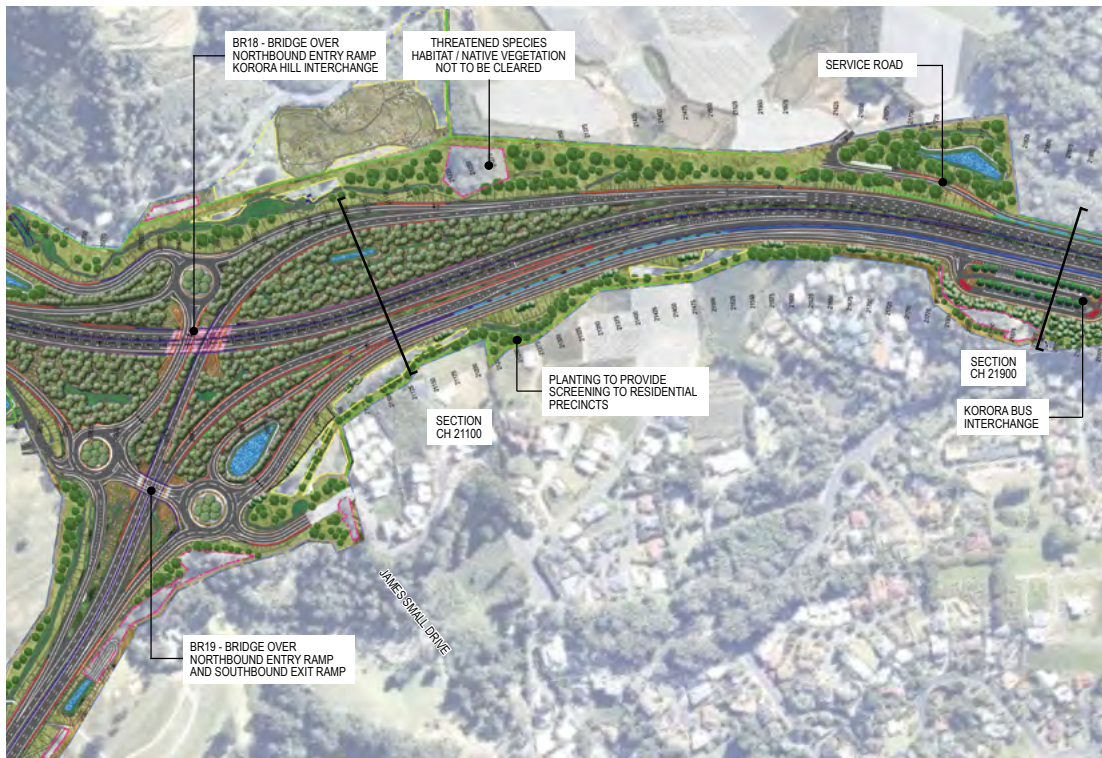

LEGEND

- CONSTRUCTION FOOTPRINT
- CLEARING BOUNDARY
- POTENTIAL VEGETATION RETENTION
- VEGETATION RETAINED
- EXPOSED ROCK CUTTING
- ROCK FILL
- FAUNA FENCE
- BOUNDARY FENCE

LANDSCAPE TREATMENTS COMPRISING A MIX OF HYDROMULCH SEED TREATMENTS AND PLANTING

- PLANTING AT NOISE WALLS, HEADLIGHT SCREENS AND RETAINING WALLS
- BUS INTERCHANGE TREES
- PROPOSED KOALA HABITAT RESTORATION
- CREEKLINE PLANTING
- INTERCHANGE TREE PLANTING
- TREE PLANTING AT NOISE WALL, ROCK FILL & OPERATIONS FACILITIES
- TURF
- INTERCHANGE GARDEN BED
- WET FOREST MIX
- OPEN FOREST MIX
- GRASSLAND AND FENCELINE MIX
- MEDIAN AND VERGE MIX
- CREEKLINE MIX
- DRAINAGE MIX
- INTERCHANGE MIX
- NOISE WALL MIX
- ANCILLARY SITE MIX

FURNITURE

- NOISE WALL
- RETAINING WALL
- TYPE F BARRIER
- W BEAM BARRIER
- WIRE ROPE SAFETY BARRIER
- HEADLIGHT SCREENS

FAUNA

- FAUNA CROSSING LOCATION

SCALE 1:1000

SERVICE ROAD	ANCILLARY SEEDING	OPEN FOREST SEEDING	GRASSLAND SEEDING
NORTHBOUND	INTERCHANGE SEEDING AND TREE PLANTING	OPEN FOREST SEEDING	
MEDIAN	INTERCHANGE SEEDING AND TREE PLANTING	MEDIAN SEEDING	
SOUTHBOUND		OPEN FOREST SEEDING	

CONCEPT PLAN - 13 of 15

Urban design concept plan – Korora Bus Interchange north

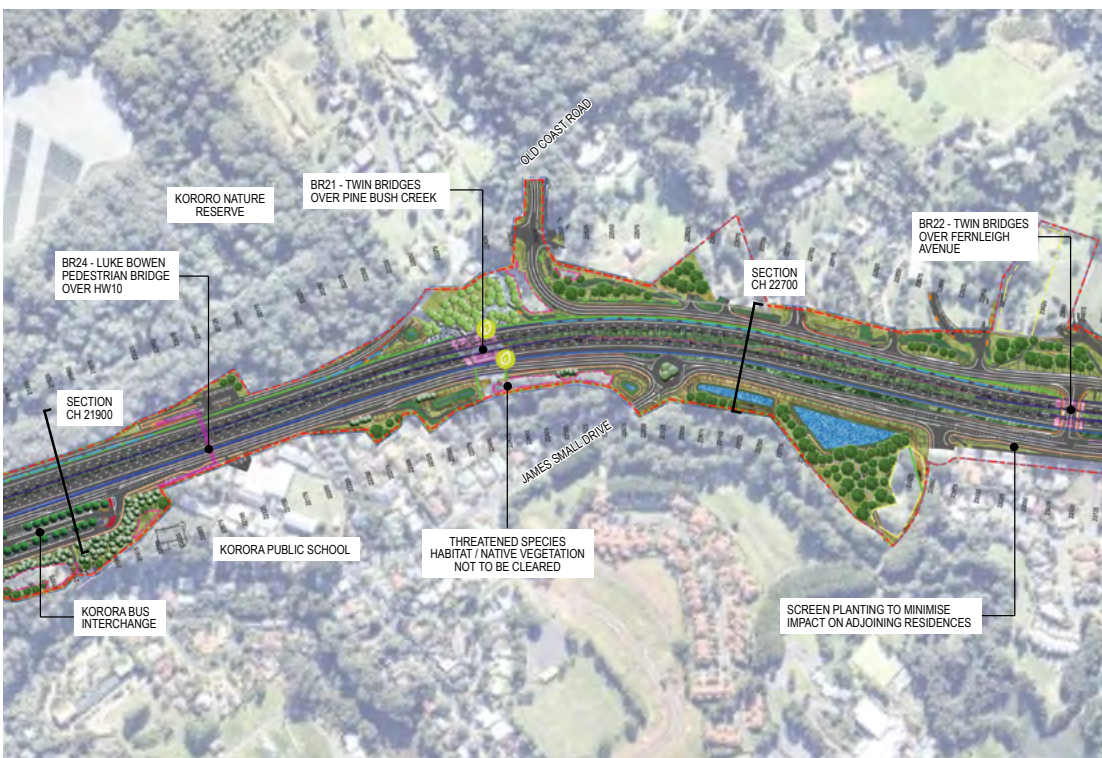

LEGEND

- CONSTRUCTION FOOTPRINT
- CLEARING BOUNDARY
- POTENTIAL VEGETATION RETENTION
- VEGETATION RETAINED
- EXPOSED ROCK CUTTING
- ROCK FILL
- FAUNA FENCE
- BOUNDARY FENCE

LANDSCAPE TREATMENTS COMPRISING A MIX OF HYDROMULCH SEED TREATMENTS AND PLANTING

- PLANTING AT NOISE WALLS, HEADLIGHT SCREENS AND RETAINING WALLS
- BUS INTERCHANGE TREES
- PROPOSED KOALA HABITAT RESTORATION
- CREEKLINE PLANTING
- INTERCHANGE TREE PLANTING
- TREE PLANTING AT NOISE WALL, ROCK FILL & OPERATIONS FACILITIES
- TURF
- INTERCHANGE GARDEN BED
- WET FOREST MIX
- OPEN FOREST MIX
- GRASSLAND AND FENCELINE MIX
- MEDIAN AND VERGE MIX
- CREEKLINE MIX
- DRAINAGE MIX
- INTERCHANGE MIX
- NOISE WALL MIX
- ANCILLARY SITE MIX

FURNITURE

- NOISE WALL
- RETAINING WALL
- TYPE F BARRIER
- W BEAM BARRIER
- WIRE ROPE SAFETY BARRIER
- HEADLIGHT SCREENS

FAUNA

- FAUNA CROSSING LOCATION

SCALE 1:1000

NORTHBOUND	OPEN FOREST SEEDING	CREEKLINE	OPEN FOREST SEEDING
MEDIAN	MEDIAN SEEDING		MEDIAN SEEDING
SOUTHBOUND		OPEN FOREST SEEDING	

CONCEPT PLAN - 14 of 15

Coffs Harbour Bypass



Artist impression of the Korora Bus Interchange from above



Artist impression of Korora Bus Interchange waiting area



Artist impression of bus shelters at Korora Bus Interchange

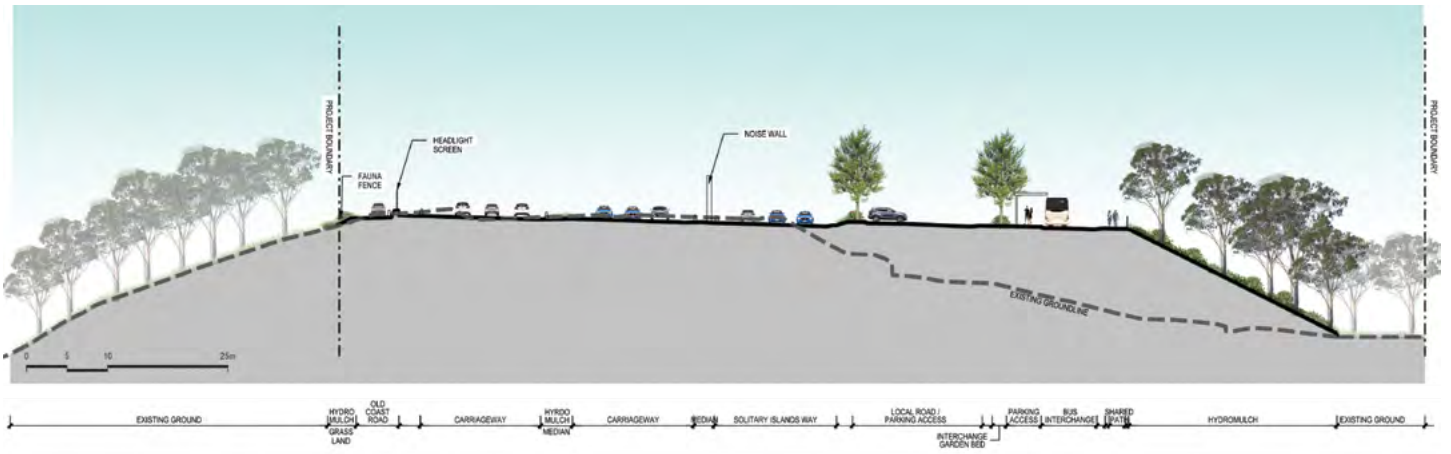

Cross section of road at Korora Bus Interchange location

Contact us

For any complaints or enquiries please contact the project team:



1800 550 621



community@chbteam.com.au



[www.pacifichighway.nsw.gov.au/
coffsharbourbypass](http://www.pacifichighway.nsw.gov.au/coffsharbourbypass)



Coffs Harbour Bypass project
PO Box 565, Toormina, NSW 2452



182 North Boambee Road,
North Boambee



If you need help understanding this information, please contact the Translating and Interpreting Service on **131 450** and ask them to call us on **1800 550 621**.

December 2023

Privacy Transport for NSW ("TfNSW") is subject to the Privacy and Personal Information Protection Act 1998 ("PPiP Act") which requires that we comply with the Information Privacy Principles set out in the PPiP Act. All information in correspondence is collected for the sole purpose of assisting in the delivery of this project. The information received, including names and addresses of respondents, may be published in subsequent documents unless a clear indication is given in the correspondence that all or part of that information is not to be published. Otherwise TfNSW will only disclose your personal information, without your consent, if authorised by the law. Your personal information will be held by TfNSW at 76 Victoria Street, Grafton, NSW, 2460. You have the right to access and correct the information if you believe that it is incorrect.

Transport for NSW

roads-maritime.transport.nsw.gov.au